

# Eden Mixer Range



See you first thing Britain

Thermostatic Mixer Shower



- A range of high quality products that form the centrepiece of the bathroom
- The design combines great looks with easy turn controls, so this range is easy on the eye and family friendly
- With performance to match, even at low water pressures

## Features:

- Contemporary all chrome design
- Lever handles are easy to grip and turn
- All fixings to complete the job
- Superior flow rates, even on a gravity system
- Durable design including ceramic disc flow control
- Thermostatic temperature control
- Separate temperature and flow controls (not sequential)
- 5 spray pattern shower head
- Ideal for family use



Eden bar mixer with kit and brackets  
**UNEDTHBM**  
Eden bar mixer with Diverter  
**UNEDTHBMDIV**



Eden Dual Control Mixer Two outlet (diverter)  
**UNEDTHDCDIV**  
Single outlet  
**UNEDTHDCMX**



Eden eco mixer  
**ECOEDTHCM**  
Eden concentric mixer  
**UNEDTHCM**  
Eden extended concentric mixer  
**UNEDTHCMEXT**



Eden Sequential Mixer Shower  
**UNEDTHSQM**

## Specification:

|                           | Bar mixer with kit<br>Bar mixer with Diverter     | Dual Control Mixer           | Concentric Eco Mixer<br>Concentric Mixer<br>Concentric Extended Mixer | Sequential Mixer                  |
|---------------------------|---|------------------------------|---|-----------------------------------|
| Temperature Control       | Thermostatic                                      | Thermostatic                 | Thermostatic  | Thermostatic                      |
| Inlet Fittings            | Push fit for pipe tails                           | n/a                          | Integral (nuts & olives supplied)                                     | Integral (nuts & olives supplied) |
| Inlet Connection          | 15mm female push fit                              | 3/4" BSP female              | 15mm female compression   | 15mm female compression           |
| Outlet Connection         | 1/2" BSP male                                     | 1/2" BSP female              | 1/2" BSP male   | 1/2" BSP male                     |
| Maximum Running Pressure* | 5 bar   | 5 bar                        | 5 bar   | 5 bar                             |
| Minimum Running Pressure* | 0.1 bar   | 0.1 bar                      | 0.1 bar   | 0.1 bar                           |
| Flow Rate (min pressure)  | 3.5 l/min   | 4.9 l/min                    | 6 l/min   | 4.8 l/min                         |
| Flow Rate 3 bar           | 25 l/min - Bar mixer<br>26.6 l/min - Bar diverter | 26.5 l/min                   | 6 l/min - Eco<br>40.8 l/min   | 31.5 l/min                        |
| Optional Limiter          | 12 l/min  | n/a                          | 6 l/min (factory fitted) - Eco<br>12 l/min                            | 12 l/min                          |
| Built-in fittings         | n/a   | 2 x front / 2 x rear lugs    | 80mm dia plate & wall outlet  | 68mm dia plate & wall outlet      |
| Built-in Depth            | n/a   | 60mm (fixings) / 65mm (body) | 60mm  | 50mm                              |

\*A minimum flow rate of 8 l/min is required from each inlet pipe at the specified pressure - check before fitting the mixer valve



# Eden Tap Range



See you first thing Britain



TMV2 Bath Shower Mixer  
**UNEDTHBSM**

TMV2 Bath Shower Mixer  
with Riser Rail Kit  
**UNEDTHBSMRR**

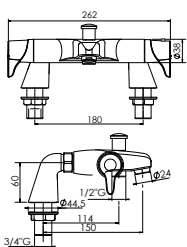

Bath Shower Mixer  
**UNEDBSM**

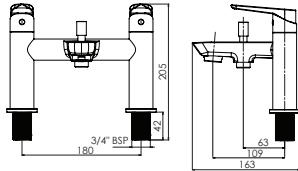

Bath Filler  
**UNEDTPBAF**

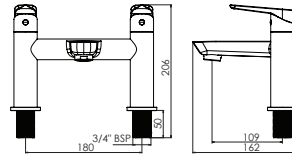

Mini Mono Basin Mixer Tap  
with Click Clack Waste\*  
**UNEDBASMM**

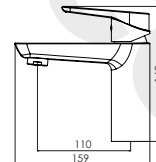

Mono Basin Mixer Tap  
with Click Clack Waste\*  
**UNEDTPBASM**

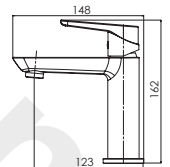

## Features:

- A range of high quality products that form the centrepiece of the bathroom
- The design combines great looks with easy turn controls, so this range is easy on the eye and family friendly
- With performance to match, even at low water pressures

## Benefits

- Metal backnuts or horseshoe plate for secure fixing
- Flexible tap connectors
- Slotted click clack waste included\*

