

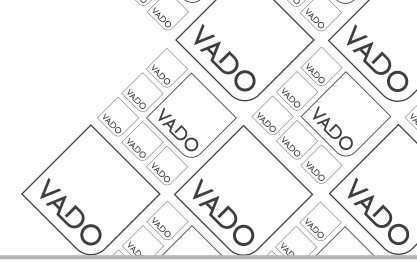

where inspiration flows



Wall basin mixers
Installation Guide

109S/A-C/P

This instruction booklet covers models:

EDI-109S/A-C/P, LIF-109S/A-C/P & LIF-109S/A-200-C/P,
NOT-109FS/A-C/P & NOT-109FS/A-220-C/P,
PHA-109FS/A-C/P, PHO-109FS/A-C/P,
SYN-109S/A-C/P, ZOO-109S/A-C/P.

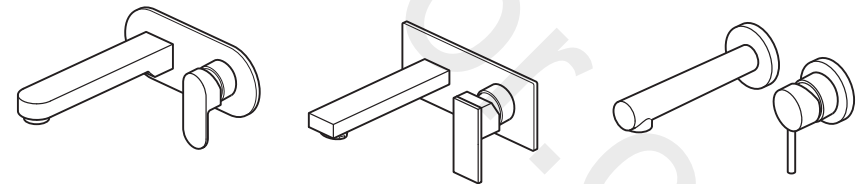

Vado
Wedmore Road, Cheddar, Somerset, England BS27 3EB
tel 01934 744466. fax 01934 744345
aftersales@vado.com
www.vado.com



Important - please read

Please read these instructions carefully before starting installation and keep for future reference.

Remove all packaging and check the product for missing parts or damage before starting installation.

Any alterations made to this product and fittings may infringe water regulations and will invalidate the guarantee.

The installation must comply with all Local/National Water Supply Authority Regulations/Byelaws and Building and Plumbing Regulations.

To be installed in accordance with BS EN806.

We strongly recommend that you use a qualified and registered plumber.

General installation

This fitting is a mixing device and therefore water supplies should be reasonably balanced.

When installed, the fitting must comply with the requirements of the Water Supply (Water Fittings) Regulations 1999 and Scottish Byelaws 2004.

For further information, contact the Water Regulations department of your local water supplier (see the WRAS website www.wras.co.uk for details) or the Water Regulations Advisory Scheme by email (info@wras.co.uk) or telephone: 01495848454.

Before making any inlet pipe connections, all supply pipes MUST be thoroughly flushed to remove debris. Failure to do so could result in damage or low flow from the mixer unit. Water Supply (Water Fittings) Regulations 1999 Schedule 2 Section 13.

The fitting of isolating valves to the inlet feeds is advised for ease of maintenance.

Please take great care when installing this mixer not to damage its surface.

Please note if installing in an enclosed environment, access should be left for servicing and maintenance. No costs relating to inadequate access can be accepted.

Operating Specifications

Operating Pressure

All models except Edit - Minimum operating pressure **0.2 bar**
(1.5 bar if used as a bath fill).

Edit - Minimum operating pressure **1.0 bar**
(1.5 bar if used as a bath fill).

Maximum operating pressure **5 bar**

Contents of Packaging

For illustration purposes only the Notion model is shown.

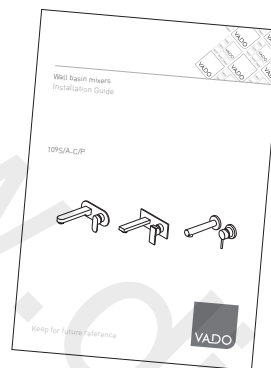

Installation Guide &
User Manual

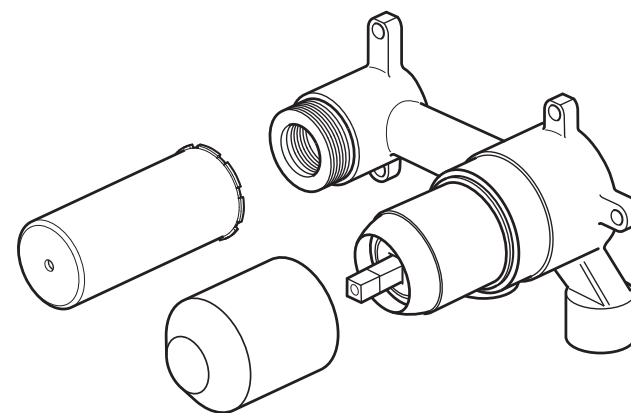

Valve with mortar guard

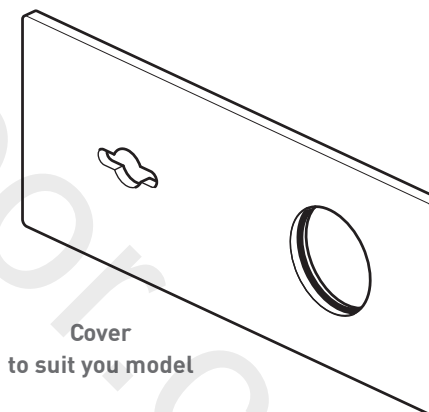
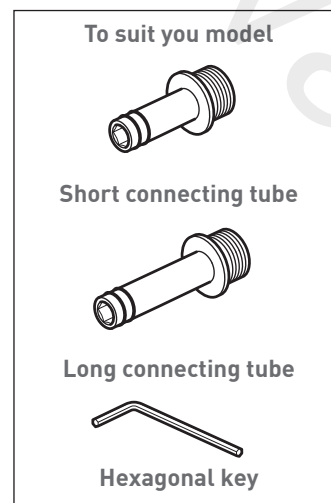

Cover
to suit you model

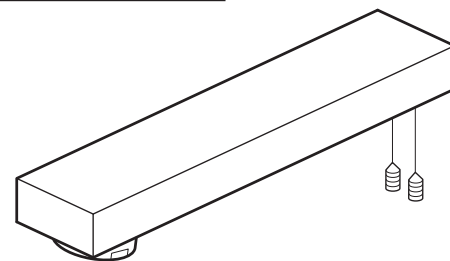

Spout with grub screws
to suit you model

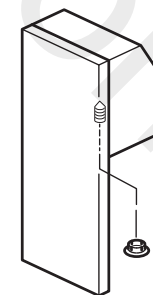

Handle with grub screw & cover
to suit you model

Dimensions

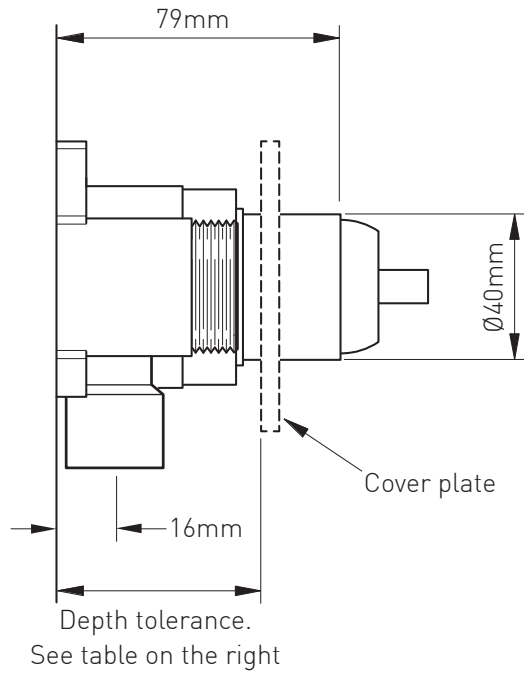

Depth tolerance.	
Model	Depth
EDI-109S/A-C/P	52-72mm
LIF-109S/A-C/P	53-70mm
NOT-109S/A-C/P	53-73mm
PHA-109S/A-C/P	53-70mm
PHO-109S/A-C/P	53-70mm
SYN-109S/A-C/P	53-70mm
ZOO-109S/A-C/P	53-72mm

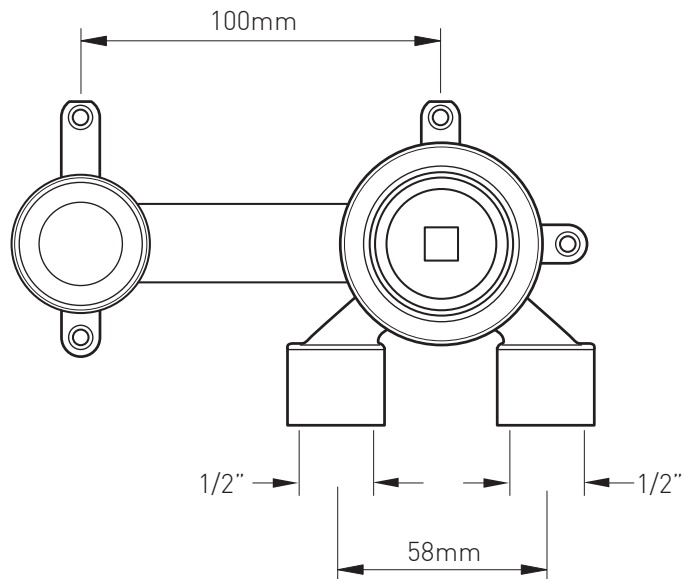

Installation - Quick guide

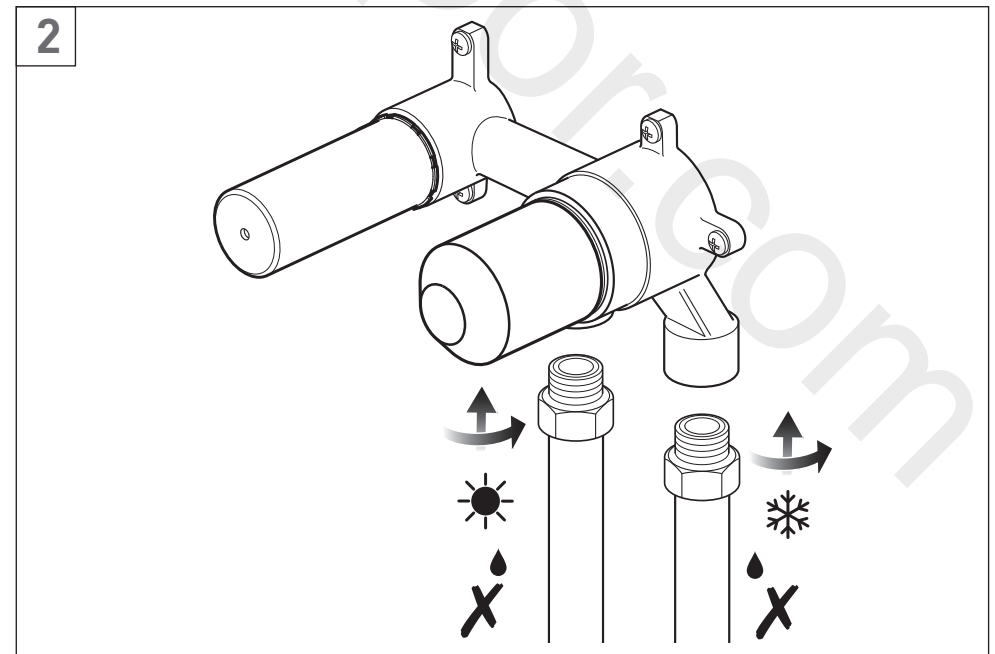
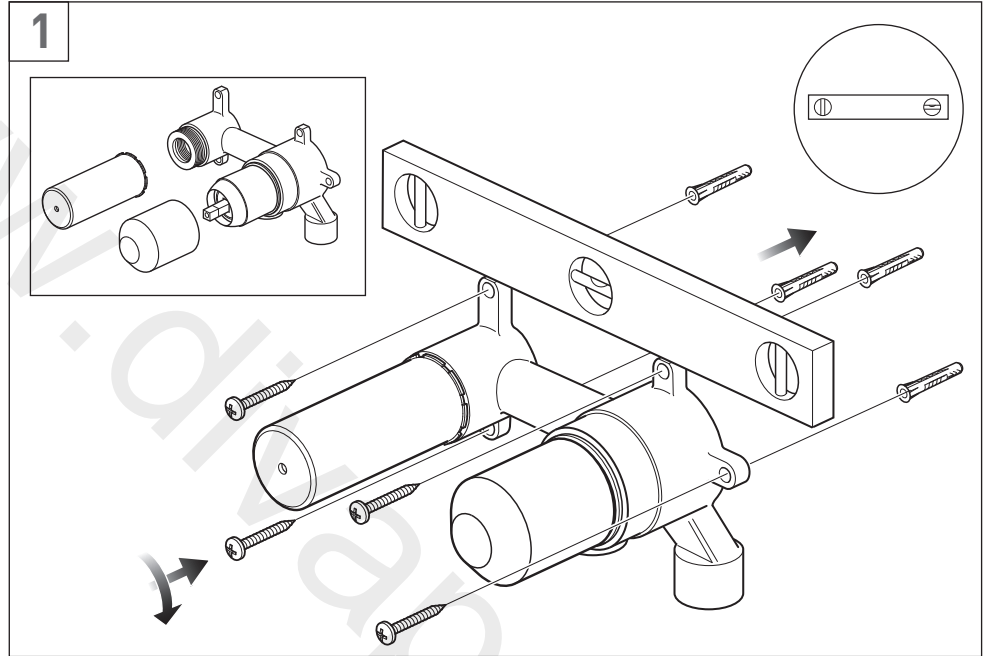

Installation - Quick guide

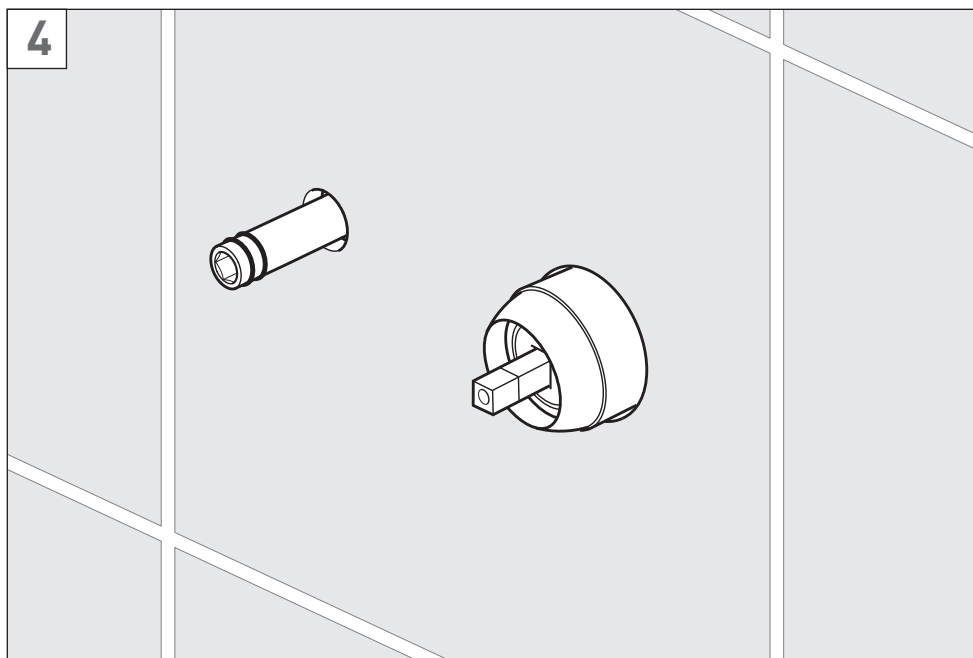
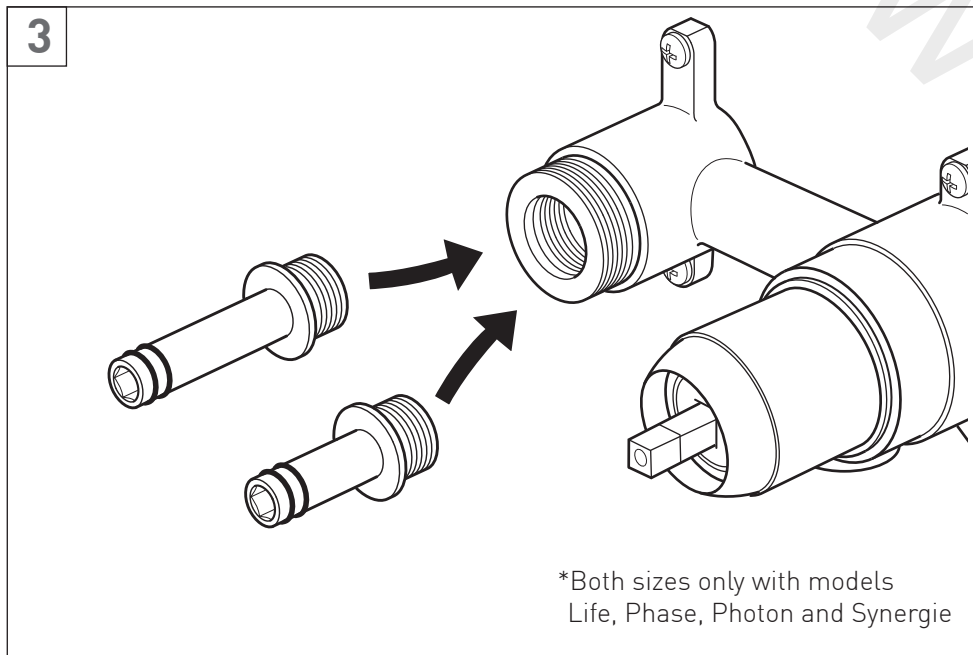

Installation - valve

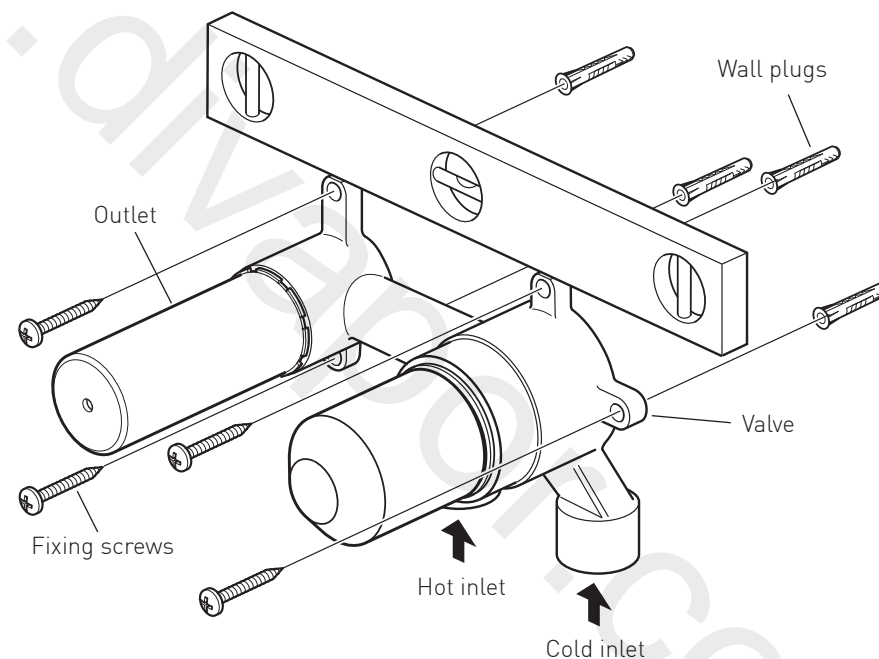
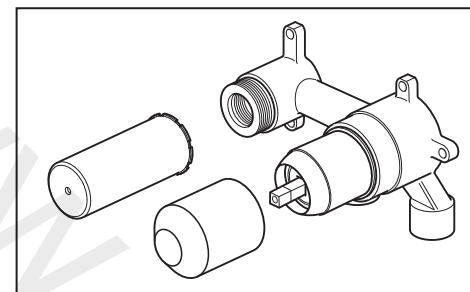

Warning! Please check for any hidden cables and pipes before drilling holes in the wall.
Before installing your new mixer, flush through pipework to ensure removal of debris, turn off the water supply.

Leave the plastic guards on during installation to avoid any damage to the valve.
The valve must be set into the wall. Please see page 4 for depth requirement dimensions.
Offer the valve up to the wall making sure it is level, mark the 4 wall fixing positions and drill holes to take suitable wall plugs and screws. Fix in position.
Make all connections to the valve. Connect hot supply to the left inlet and cold supply to the right inlet.

Installation

Using PTFE tape on the thread, screw the connecting tube into the valve and tighten with a hex key.

Edit, Notion, and Zoo.

Screw the supplied connecting tube into the valve and tighten.

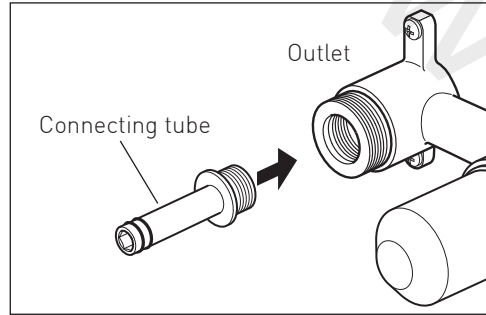

Life, Phase, Photon and Synergie.

These models are supplied with a choice of 2 connecting tubes to give the depth tolerance required for installation.

53mm-63mm for the short connecting tube.
63mm-73mm for the long connecting tube.

Screw the chosen connecting tube into the valve and tighten.

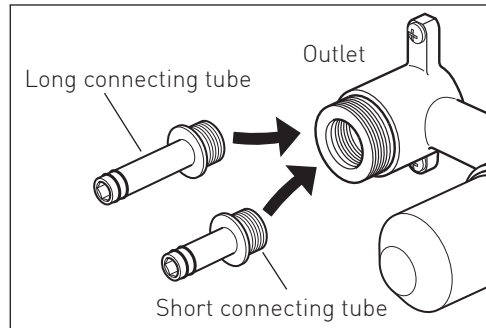

Installation - Edit

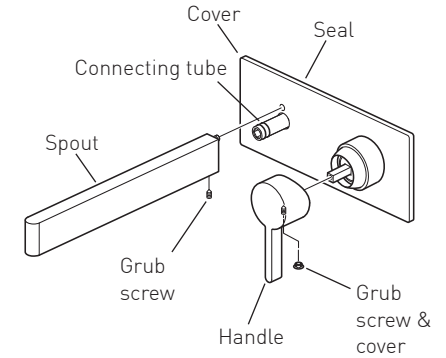
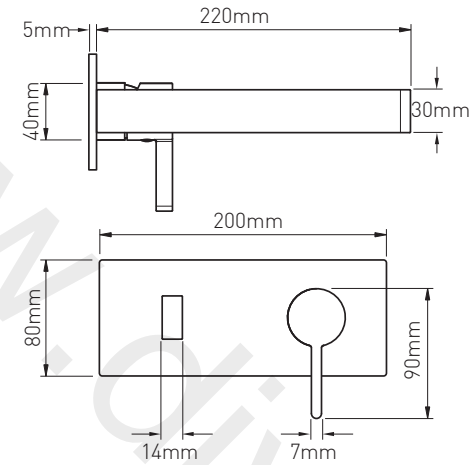

Remove the backing paper from the seal on the back of the cover. Slide the cover over the valve, push onto the wall until it makes contact. Carefully slide the control handle onto the valve and secure in position with the grub screw within the handle using the hexagonal key supplied, replace the screw cover. Push the spout over the connecting tube, secure using the grub screw on the underside. Apply a small bead of silicone around the plate to seal against the tile.

Installation - Life

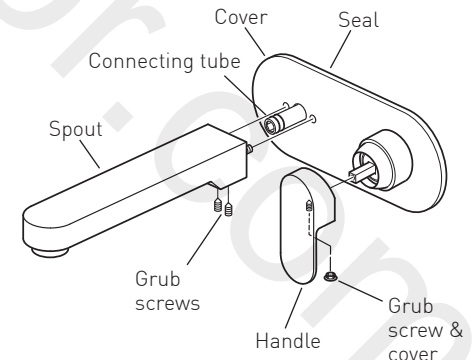
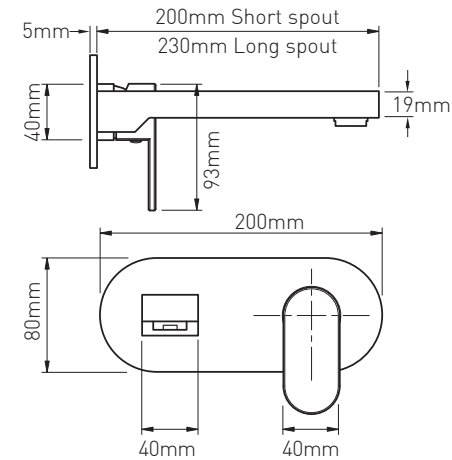

Remove the backing paper from the seal on the back of the cover. Slide the cover over the valve, push onto the wall until it makes contact. Carefully slide the control handle onto the valve and secure in position with the grub screw within the handle using the hexagonal key supplied, replace the screw cover. Push the spout over the connecting tube, secure using the grub screws on the underside. Apply a small bead of silicone around the plate to seal against the tile.

Installation - Notion

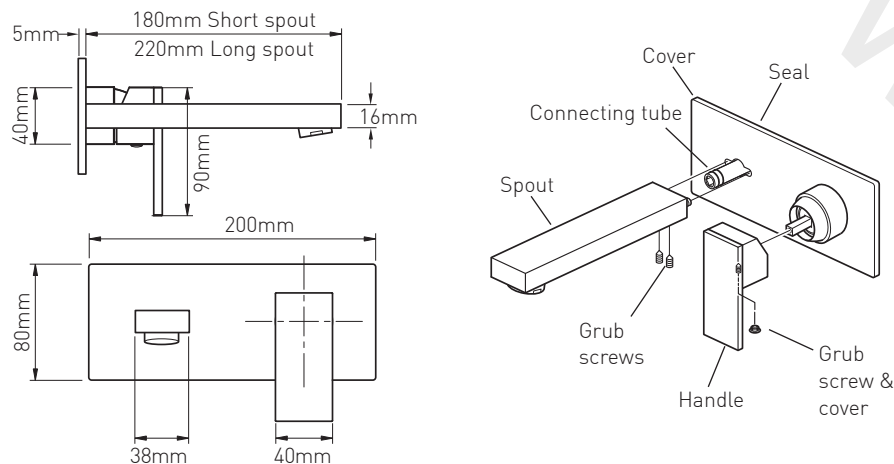

Remove the backing paper from the seal on the back of the cover. Slide the cover over the valve, push onto the wall until it makes contact.
Carefully slide the control handle onto the valve and secure in position with the grub screw within the handle using the hexagonal key supplied, replace the screw cover.
Push the spout over the connecting tube, secure using the grub screws on the underside.
Apply a small bead of silicone around the plate to seal against the tile.

Installation - Photon

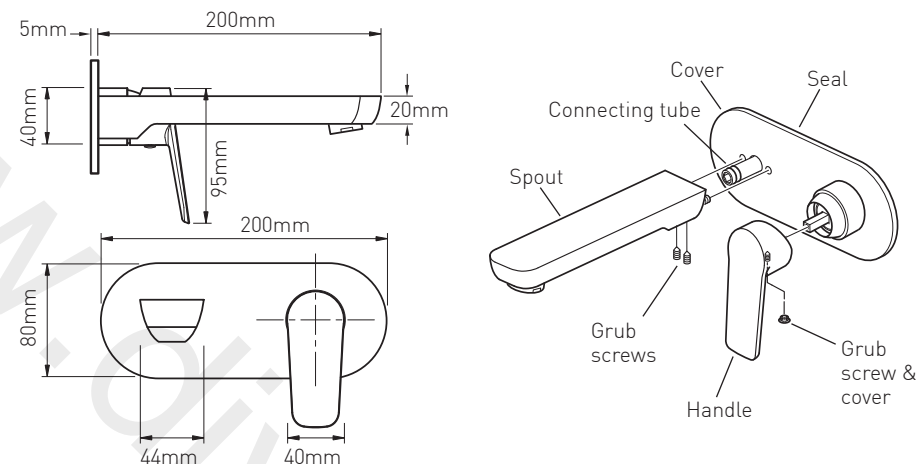

Remove the backing paper from the seal on the back of the cover. Slide the cover over the valve, push onto the wall until it makes contact.
Carefully slide the control handle onto the valve and secure in position with the grub screw within the handle using the hexagonal key supplied, replace the screw cover.
Push the spout over the connecting tube, secure using the grub screws on the underside.
Apply a small bead of silicone around the plate to seal against the tile.

Installation - Phase

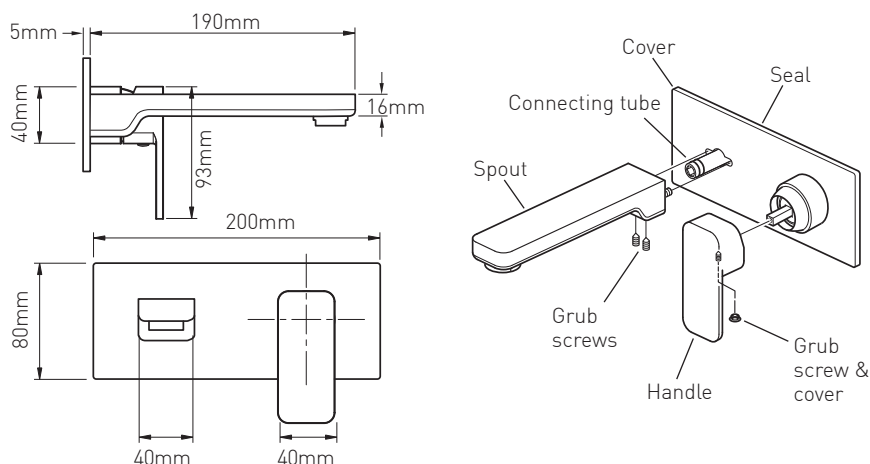

Remove the backing paper from the seal on the back of the cover. Slide the cover over the valve, push onto the wall until it makes contact.
Carefully slide the control handle onto the valve and secure in position with the grub screw within the handle using the hexagonal key supplied, replace the screw cover.
Push the spout over the connecting tube, secure using the grub screws on the underside.
Apply a small bead of silicone around the plate to seal against the tile.

Installation - Synergie

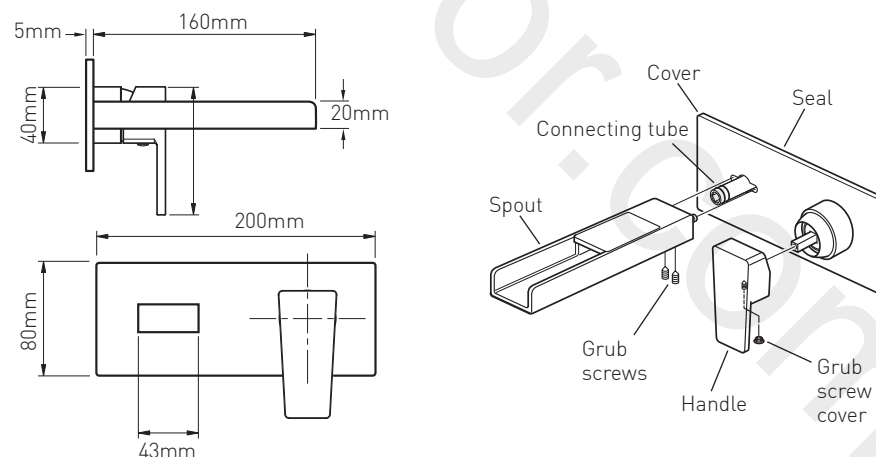

Remove the backing paper from the seal on the back of the cover. Slide the cover over the valve, push onto the wall until it makes contact.
Carefully slide the control handle onto the valve and secure in position with the grub screw within the handle using the hexagonal key supplied, replace the screw cover.
Push the spout over the connecting tube, secure using the grub screws on the underside.
Apply a small bead of silicone around the plate to seal against the tile.

Installation - Zoo

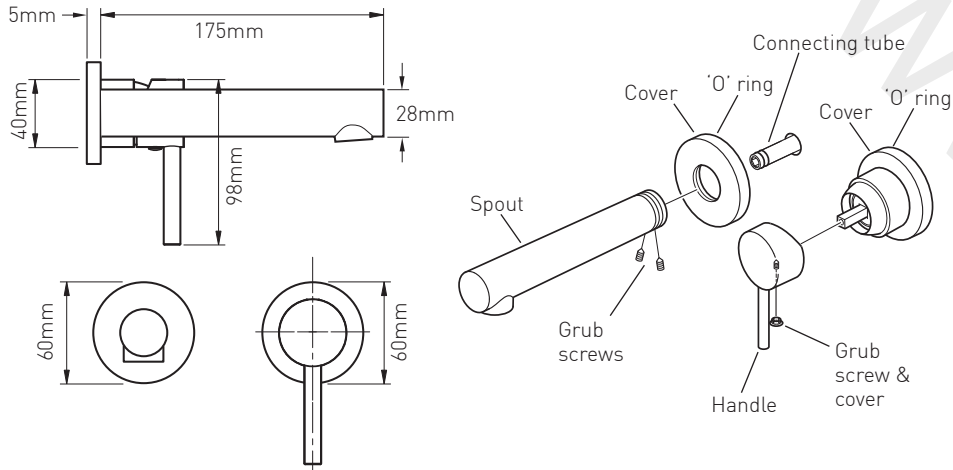

Slide the cover over the valve, push onto the wall until it makes contact.
 Carefully slide the control handle onto the valve and secure in position with the grub screw within the handle using the hexagonal key supplied, replace the screw cover.
 Screw the spout into the cover. Push the spout over the connecting tube, secure using the grub screws on the underside.
 Apply a small bead of silicone around the plate to seal against the tile.

Operation

Note: For illustrative purposes only the Notion version is shown. The same operation applies to all the other shower valves.

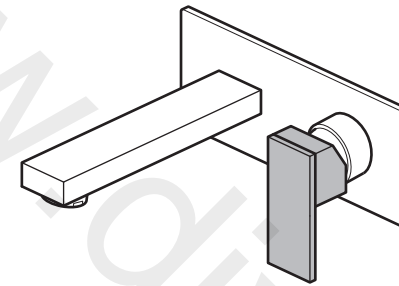

Handle in the **Off** position

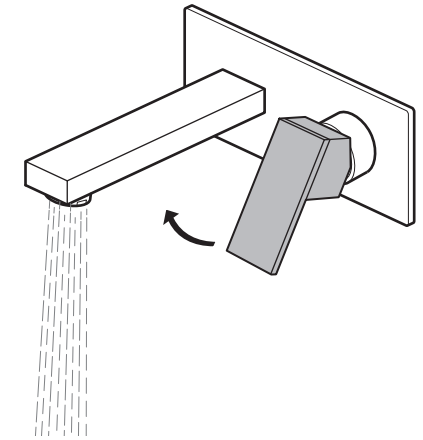

Pull out the handle to increase the flow of water.

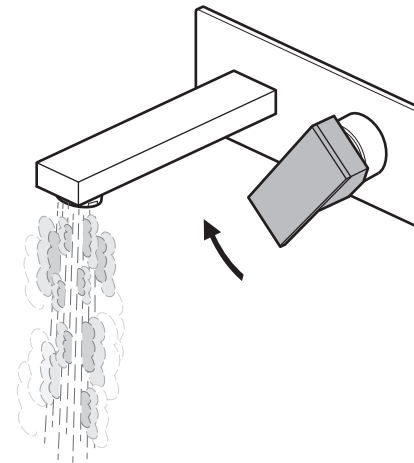

Turning the handle clockwise will increase the flow of hot water.

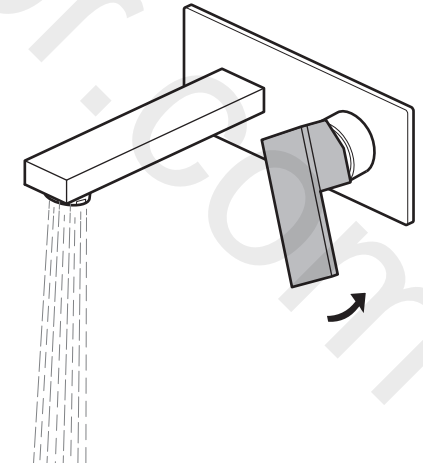

Turning the handle anti-clockwise will increase the flow of cold water.

Guarantee

All VADO products come with a 2 year guarantee as standard. Within this guarantee period VADO will provide replacement parts and any labour **[SEE NOTE 1]** needed to complete the product repair.

This standard guarantee may be extended by registering your product to give up to a 15 year guarantee period. Once registered:

VADO chromed brassware and stainless steel products have a 15 year guarantee (2 years parts and labour plus 13 years parts only).

VADO Sensori SmartTouch and SmartDial products have a 5 year guarantee (parts and labour).

VADO Identity and i-tech products have a 5 year guarantee (2 year parts and labour plus 3 years parts only).

All other VADO products have a 3 year guarantee (2 years parts and labour plus 1 year parts only) **[SEE NOTE 2]**.

Guarantee Conditions

Our products are guaranteed against manufacturing defects from the date of purchase until the expiry of the relevant guarantee period shown above.

The guarantee is only valid if:

- The product has been installed, used and maintained in accordance with VADO's instructions and subjected to normal use only.
- The defect is not due to use of an unsuitable or inadequate water or power supply.
- The defect is not due to accident, misuse, neglect or incorrect/inappropriate repair (other than by VADO or VADO authorised agents) or damage caused by foreign objects or substances.

- The extended guarantee is only available if you have completed the Guarantee Registration Process. This can be done via the VADO website or via phone to our aftersales team. Registration must be completed within 6 months from date of purchase.

Under the extended guarantee period VADO will, at its option, offer to supply any replacement product (or component part) assessed to be defective **[SEE NOTE 3]**.

The guarantee (whether standard or extended) is non-transferable to any subsequent owner. All claims under the guarantee should be notified in the first instance to our Aftersales department, contact details below, this must be done no later than the last day of the relevant guarantee period.

All claims must be accompanied by proof of purchase (sales receipt or delivery note) from an official VADO dealer.

The guarantee does not extend to any consequential loss or damage.

After repair or replacement, the relevant guarantee period will be calculated from the original date of purchase.

VADO operates a policy of continuous product development and therefore reserves the right to change the product, packaging and documentation specifications without notice. E&OE.

NOTES:

[1] Labour via our engineer network is only available in the UK. Attendance by a VADO engineer or sub-contract engineer will be under our standard terms and conditions.

[2] VADO spare parts and shower hoses are under a parts only guarantee.

[3] VADO reserves the right to charge in advance for a product (or replacement part) pending collection and investigation (at VADO expense) to confirm a defect is due to a manufacturing issue.

If a defect is found the charge will be refunded or cancelled.

This guarantee is in addition to and does not affect your statutory rights as a consumer.

Tel: 01934 745163

Email: aftersales@vado.com