

inta

Intatherm Thermostatic Basin Tap IT1001CP, IT1003CP, IT1001CT & IT1003CT Installation and Maintenance Instructions

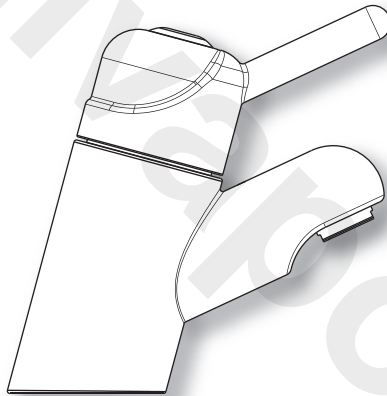

inta

Intatec Ltd

Airfield Industrial Estate
Hixon
Staffordshire
ST18 0PF

In this procedure document we have endeavoured to make the information as accurate as possible.

We cannot accept any responsibility should it be found that in any respect the information is inaccurate or incomplete or becomes so as a result of further developments or otherwise.

Tel: **01889 272 180**

Fax: **01889 272 181**

email: **sales@intatec.co.uk**

web: **www.intatec.co.uk**

Introduction

This installation guide has been produced for the Intatherm thermostatic basic mixer taps. These instructions cover the installation, operation and maintenance. Please read the enclosed instructions before commencing the installation of this product, please note;

We recommend that the installation of any Inta product is carried out by an approved installer.

The installation must be carried out strictly in accordance with the Water Supply (Water Fitting) Regulations 1999 and any local authority regulations.

If in doubt we recommend that you contact WRAS - Water Regulations Advisory Scheme on Tel: 0333 207 9030, your local water authority - details available on the WRAS website or the Chartered Institute of Plumbing and Heating Engineers on Tel: 01708 472 791.

All products **MUST** be re-commissioned to suit site conditions to ensure optimum performance levels of the product are obtained.

Safety

The Intatherm thermostatic basin mixer taps contains an integral thermostatic cartridge to prevent scalding.

This thermostatic mixer taps must be installed and commissioned correctly to ensure that water is supplied at a safe temperature to suit the users.

43°C is the maximum mixed water temperature from a mixer tap. The maximum temperature takes account of the allowable tolerances inherent in thermostatic mixer taps and temperature losses.

It is not a safe washing temperature for adults or children.

The British Burns Association recommends 37 to 37.5°C as a comfortable washing temperature for children. In premises covered by the Care Standard Act 2000, the maximum mixed water outlet temperature is 43°C.

Products

| | |
|--|----------|
| Intatherm thermostatic basin mixer tap with flexible tail | IT1001CP |
| Intatherm thermostatic basin mixer tap with flexible tails | IT1003CP |
| Intatherm thermostatic basin mixer tap with copper tails | IT1001CT |
| Intatherm thermostatic basin mixer tap with copper tails | IT1003CT |

Check Content

Before commencing remove all components from packaging and check each component with the contents list.

Ensure all parts are present, before discarding any packaging. If any parts are missing, do not attempt to install your Inta tap until the missing parts have been obtained.

Components

| Item | Qty | Component |
|------|-----|------------------------|
| 1 | 1 | Body |
| 2 | 1 | Indice |
| 3 | 1 | Retaining screw |
| 4 | 1 | Handle |
| 5 | 1 | Temperature stop ring |
| 6 | 1 | Thermostatic cartridge |
| 7 | 1 | Seat |

| Item | Qty | Component |
|------|-----|----------------------------------|
| 8 | 1 | Diffuser seal |
| 9 | 1 | Diffuser |
| 10 | 1 | Fixing kit |
| 11 | 2 | Flexible tail |
| 12 | 2 | Check valve - flexible tail only |
| 13 | 2 | Copper tail |

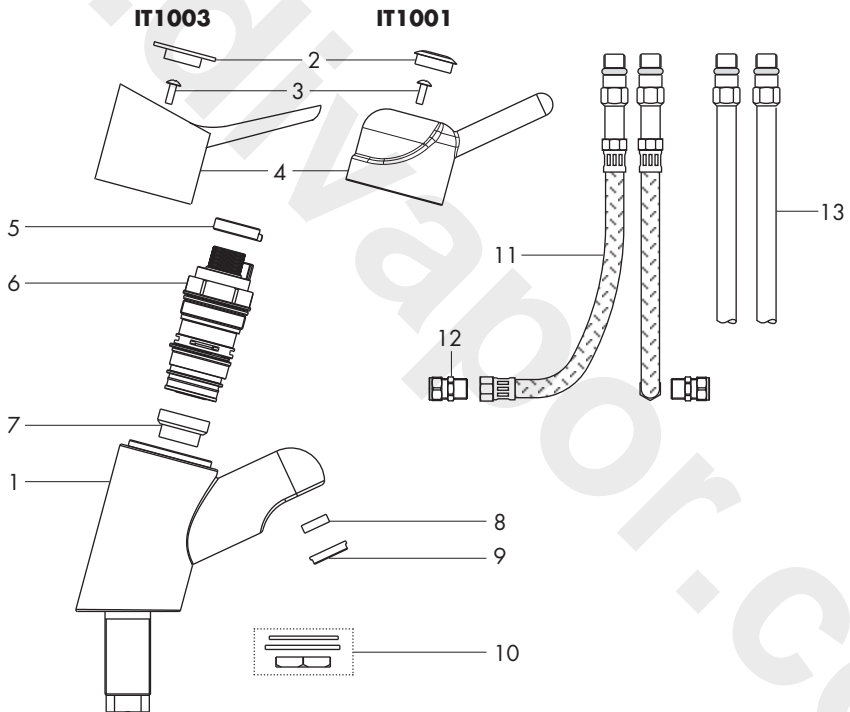

Technical Data

This Intatherm thermostatic mixer tap is suitable for installations on all types of plumbing system, including gravity supplies, fully pumped, modulating combination boiler, unvented water heater and unbalanced supplies i.e. Cold Mains & Tank Fed Hot. They are not suitable for non-modulating combination boilers.

| | | | |
|----------------------------------|---------|-------------------------------|------|
| Max Inlet Pressure (Static) | 10 bar | Max Unbalanced Pressure Ratio | 15:1 |
| Max Inlet Pressure (Dynamic) | 5 bar | with flow regulator | |
| Max Inlet Temperature | 85°C | Max Unbalanced Pressure Ratio | 5:1 |
| Min Inlet Temperature | 10°C | without flow regulator | |
| Pre Set Factory Temp Setting | 43°C | Min Temp Differential to | |
| Min Operating Pressure (Dynamic) | 0.2 bar | ensure fail-safe between hot | |
| Temperature Stability | ±2°C | and cold supplies | 10°C |

Dimensions

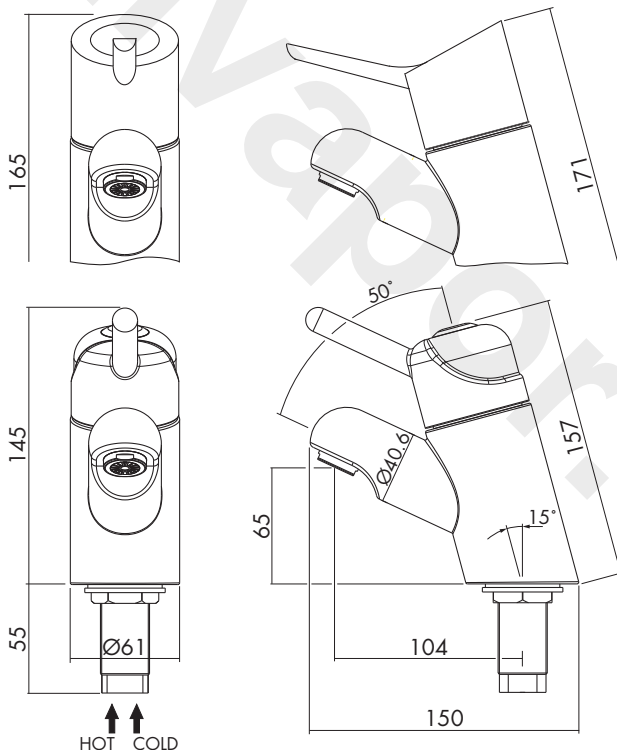

Installation

Flush the water supply pipes thoroughly prior to installation. Do not allow debris, PTFE tape or any metal particles to enter the mixer.

The Intatherm thermostatic basin tap is designed for installing on a one hole basin with a hole size of 30mm to 36mm.

The IT1001CT and IT1003CT taps are supplied with two copper tails and the IT1001CP and IT1003CP are supplied with two flexible tails and check valves.

We recommend that independent filters, isolation valves and check valves (supplied with flexible tails only) are fitted in an accessible position in conjunction with this product for servicing purposes (not supplied).

The cold supply must be connected to the right hand side and the hot to the left hand side of the mixer when viewed from the front.

Fit the two check valves to the flexible tails.

Screw the copper tails or flexible tails into the tap and tighten to make a water tight joint, do not over tighten.

Ensure that the rubber gasket is located in the base of the tap prior to fitting the mixer to the basin.

Once in place using the washer and retaining nut secure in position, taking care not to over tighten the retaining nut.

Connect the tails to the hot and cold supplies remembering which was connected to the hot inlet and ensure all joints are water tight.

For optimum mixing performance where the hot and cold pressures are not equal, regulating valves should be installed directly upstream of the tap so that the water supply pressures can be regulated and equalised.

Operation

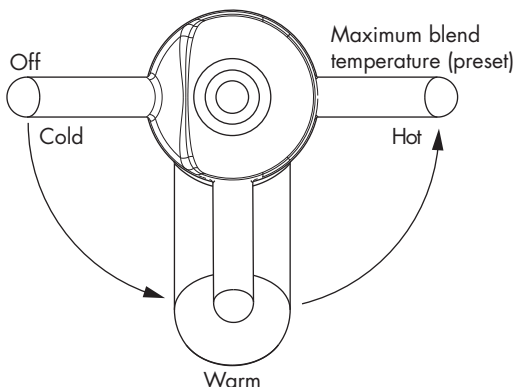

As the handle is rotated anti-clockwise from the off position the mixed water temperature progresses from cold through warm to the preset maximum temperature approximately 43°C

Calibration

The Intatherm thermostatic basin mixer tap has a factory set outlet temperature of 43°C which can be altered to suit site conditions

Warning: Care must be taken when altering the setting as incorrect calibration can cause injury.

- Taking care not to damage the tap body remove the indice and retaining screw from the mixer handle.
- Fully open the flow control to establish a stable flow of water at the maximum temperature set point.
- Remove the handle from the body.
- Remove the temperature stop ring from the cartridge and set the mixed water to the required temperature.
- Once the required temperature is achieved replace the temperature stop ring on the splined spindle of the cartridge as shown.
- Re-assemble the handle.

Cartridge Replacement

- Isolate both the hot and cold water supplies
- Remove indice from the Handle.
- Remove the screw and lift the handle from the tap body.
- The thermostatic cartridge is a single piece construction and should be unscrewed from the mixer body using a 36mm A/F socket
- When re-installing the cartridge into the mixer body it should be tightened to a maximum of 15 Nm.
- Re-commission the mixer in accordance with the instructions enclosed.

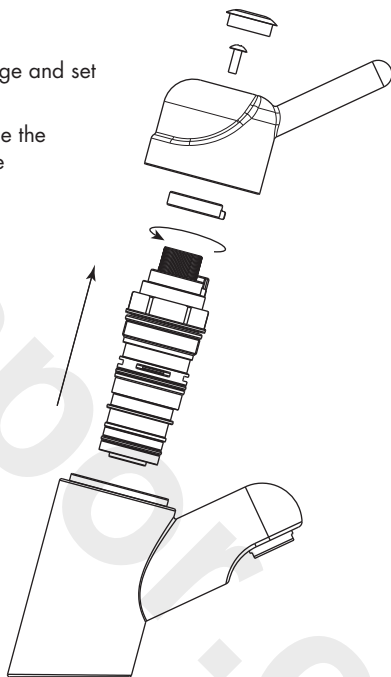

Aftercare

The diffuser should be cleaned periodically to remove any build up of debris or deposits which may affect the performance of the tap.

Inta taps have a high quality finish and should be treated with care.

An occasional wipe with a mild washing-up liquid on a soft damp cloth followed by a thorough rinsing is all that is required.

Do not use an abrasive or chemical household cleaner as this may **cause damage**.

Notes

www.divapor.com

inta

Please leave this Manual for the User

To activate your product warranty please visit
www.intatec.co.uk
and click on Product Registration

inta

Intatec Ltd

Airfield Industrial Estate
Hixon
Staffordshire
ST18 0PF

Tel: **01889 272 180**

Fax: **01889 272 181**

email: **sales@intatec.co.uk**

web: **www.intatec.co.uk**

E & O.E

© Intatec Ltd 2015

23-08-16