

Shower - MADISON

Wall valve clockwise closing 1/2"

Article number: 36 607 361-06

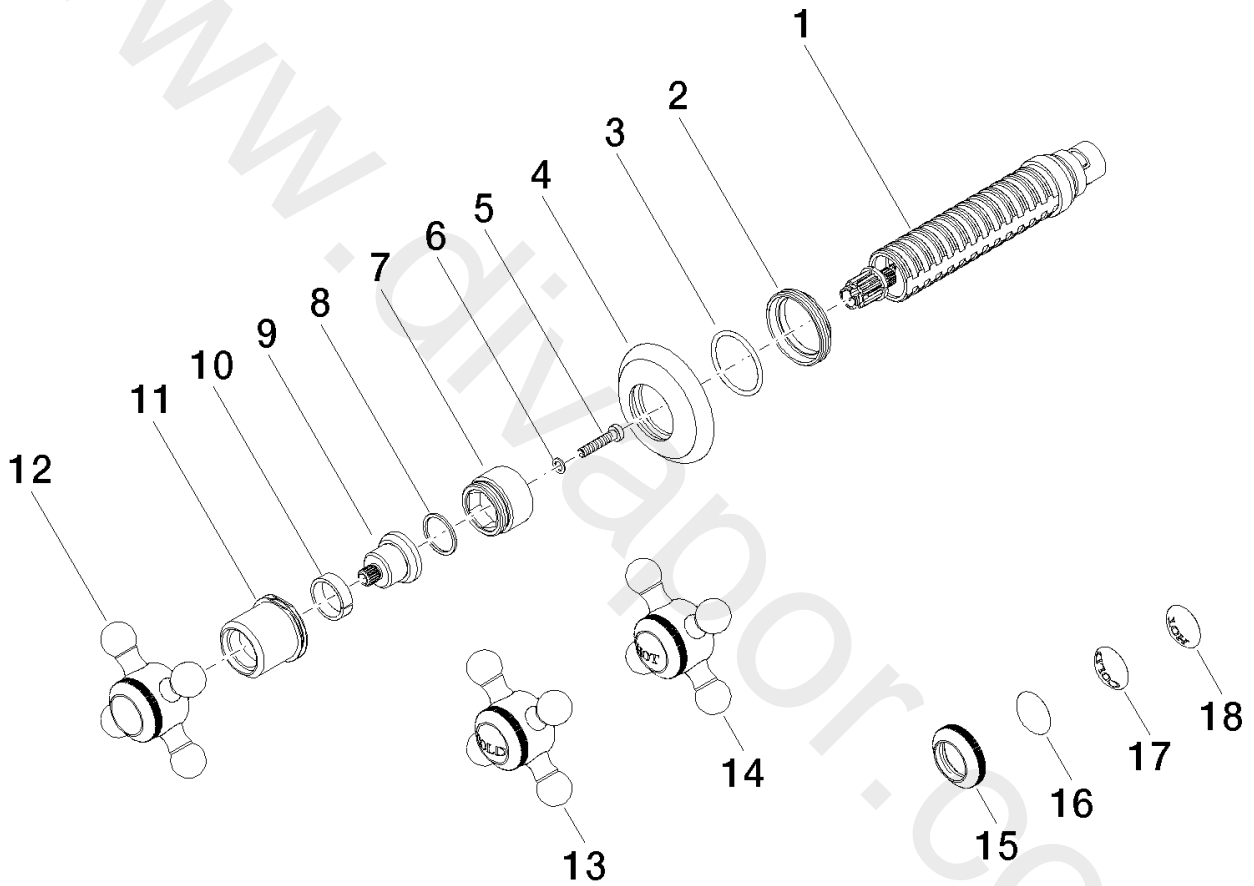



Shower - MADISON

Wall valve clockwise closing 1/2"

Article number: 36 607 361-06

Spare parts list

Position	Quantity used	Item Number	Spare part	Delivery time
1	1	90 90 03 143 00 90	top	2
2	1	09 23 10 125-00	nut	10
3	1	09 14 10 063 90	seal	2
4	1	09 27 36 102-06	rosette	10
5	1	09 30 30 075 90	screw	2
6	1	09 30 11 194 90	disc	2
7	1	09 18 30 007-06	sleeve	-
8	1	09 28 10 030 90	ring	2
9	1	09 12 12 064-06	base	-
10	1	09 14 15 021 90	ring	2
11	1	09 21 02 161-06	cover	10
12	1	04 20 36 100 02-06	handle	10
13	1	04 20 36 100 00-06	handle (cold)	10
14	1	04 20 36 100 01-06	handle (hot)	10
15	1	09 20 36 005-06	handle	10
16	1	09 26 01 016 90	accessories	2
17	1	09 26 01 010 90	accessories	2
18	1	09 26 01 011 90	accessories	2