

**Spey Thermostatic Exposed Shower Valve Single Outlet  
with Swivel Shower Arm - SF1S**

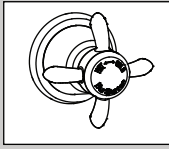
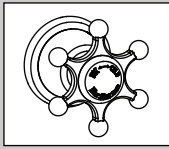

**Options:**  
When using these additional handles the indices will need to be utilised from the original handles.

**NOT INCLUDED IN THE BOX**

**Options:**  
Burlington has a shower head of 3 different sizes for your selection.

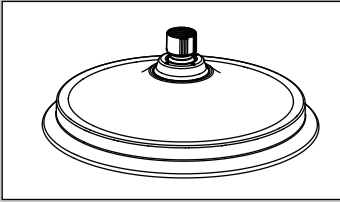

**NOT INCLUDED IN THE BOX**

**Riser:**



**NOT INCLUDED IN THE BOX**

**Important**

Before installation, ensure you have all the parts required for installation and using. If you are unsure, please contact our technical support team.

Ensure this product is the correct model and you have all the parts required for installation and using.

A pressure reducing valve to be fitted.

The valve has been designed to be compliant with the relevant UK standards applicable to this type of product governed by TMV2 standards and WRC. The valve is tested against BS EN 1111.

**Conditions for the use of thermostatic mixing valve**

The thermostatic valve has been designed to be compliant with the relevant UK standards applicable to this type of product governed by TMV2 standards and WRC. The valve is tested against BS EN 1111.

The valve will operate under low pressure but it is recommended that the cold water supply is at least 2 meters from the outlet of the shower valve.

We recommend pressure reducing valves to be fitted.)

The list below shows the recommended limits for correct operation;

	Low Pressure
Working Pressure	WR
Hot Supply Temperature - °C	WR
Cold Supply Temperature - °C	TXDOWRRUOHVVWKDQ

The list below shows the recommended limits for correct operation;

## Dimension

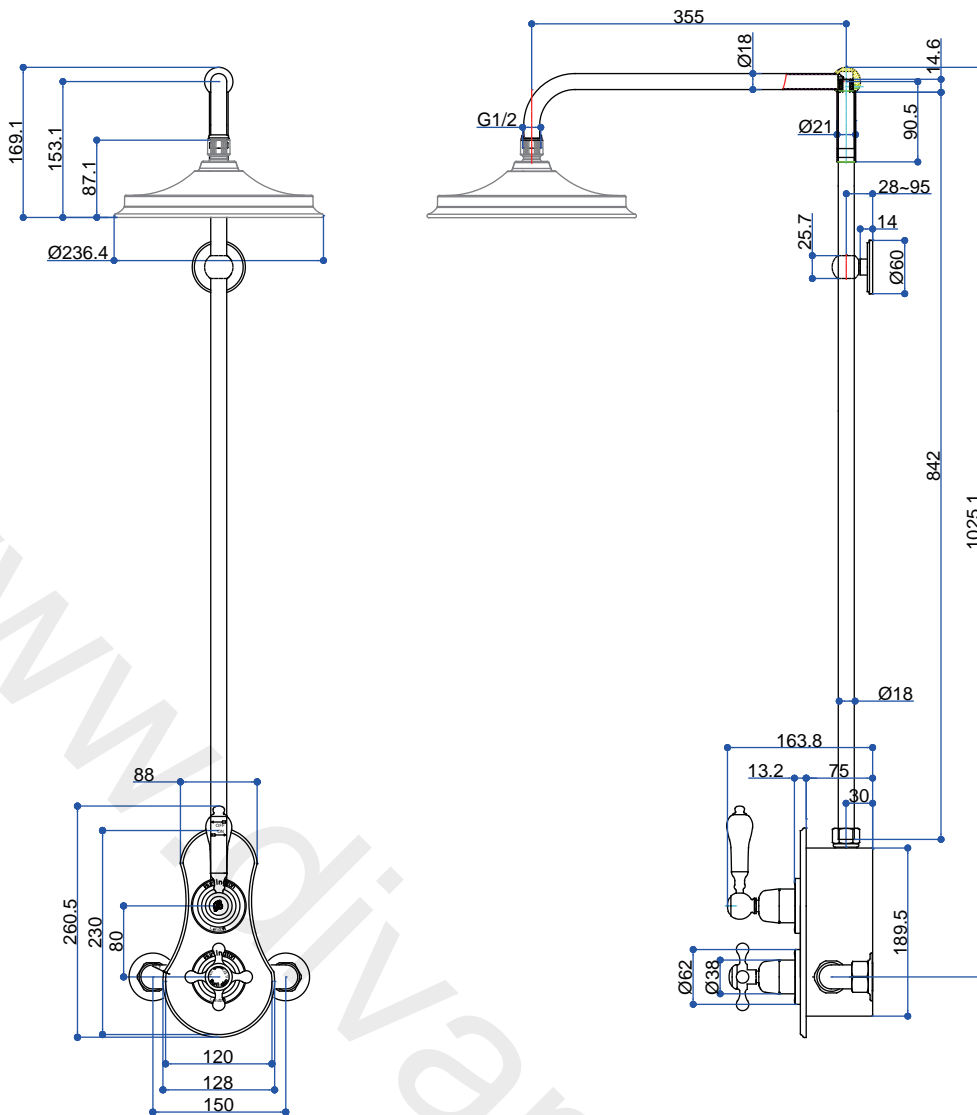

## Parts Identification

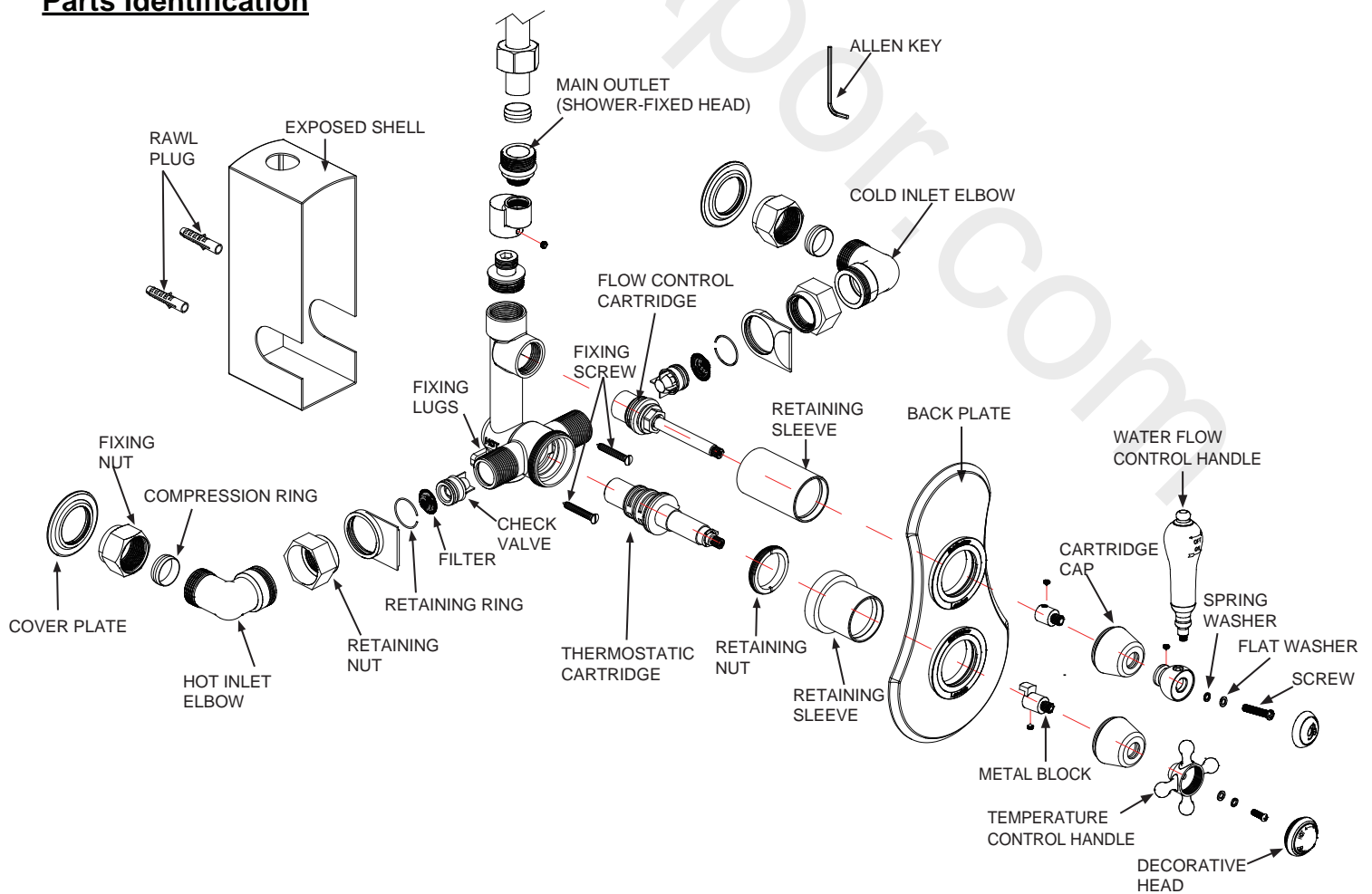

# Installation

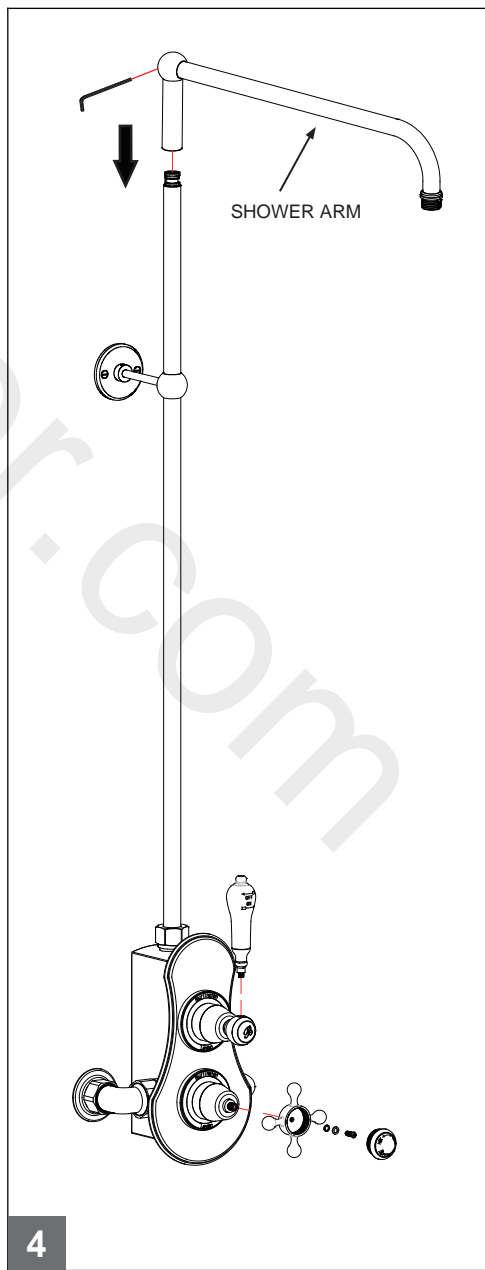
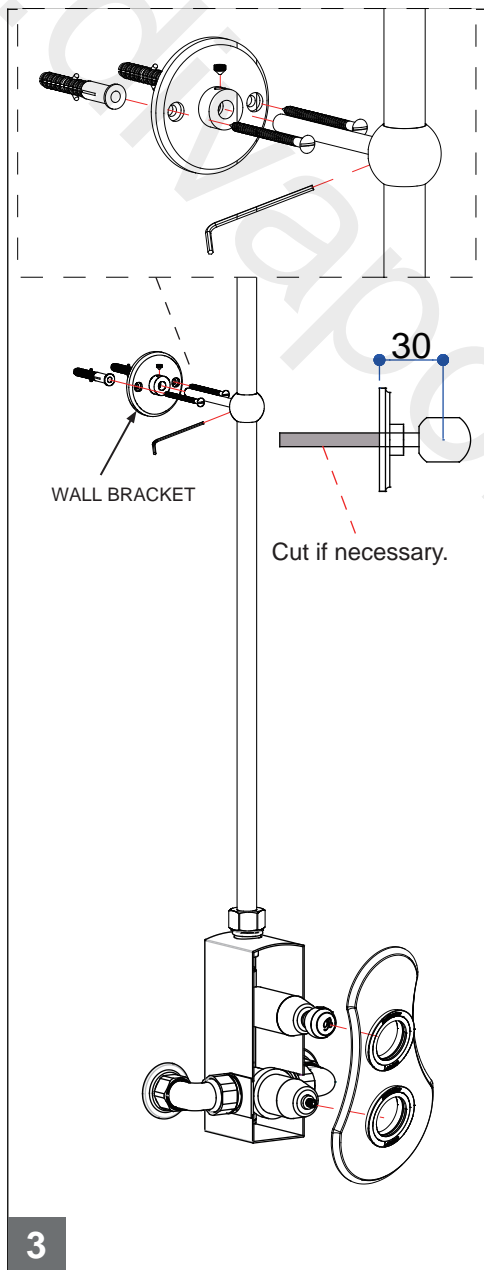
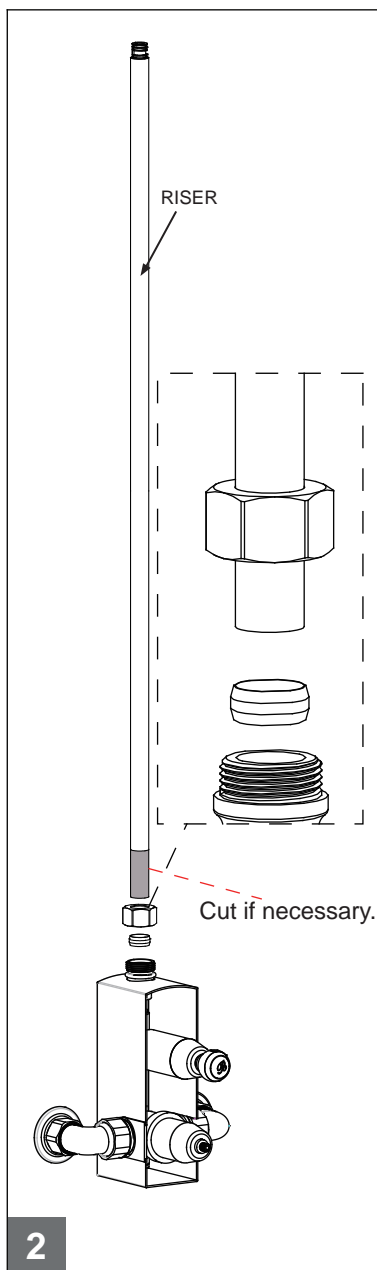
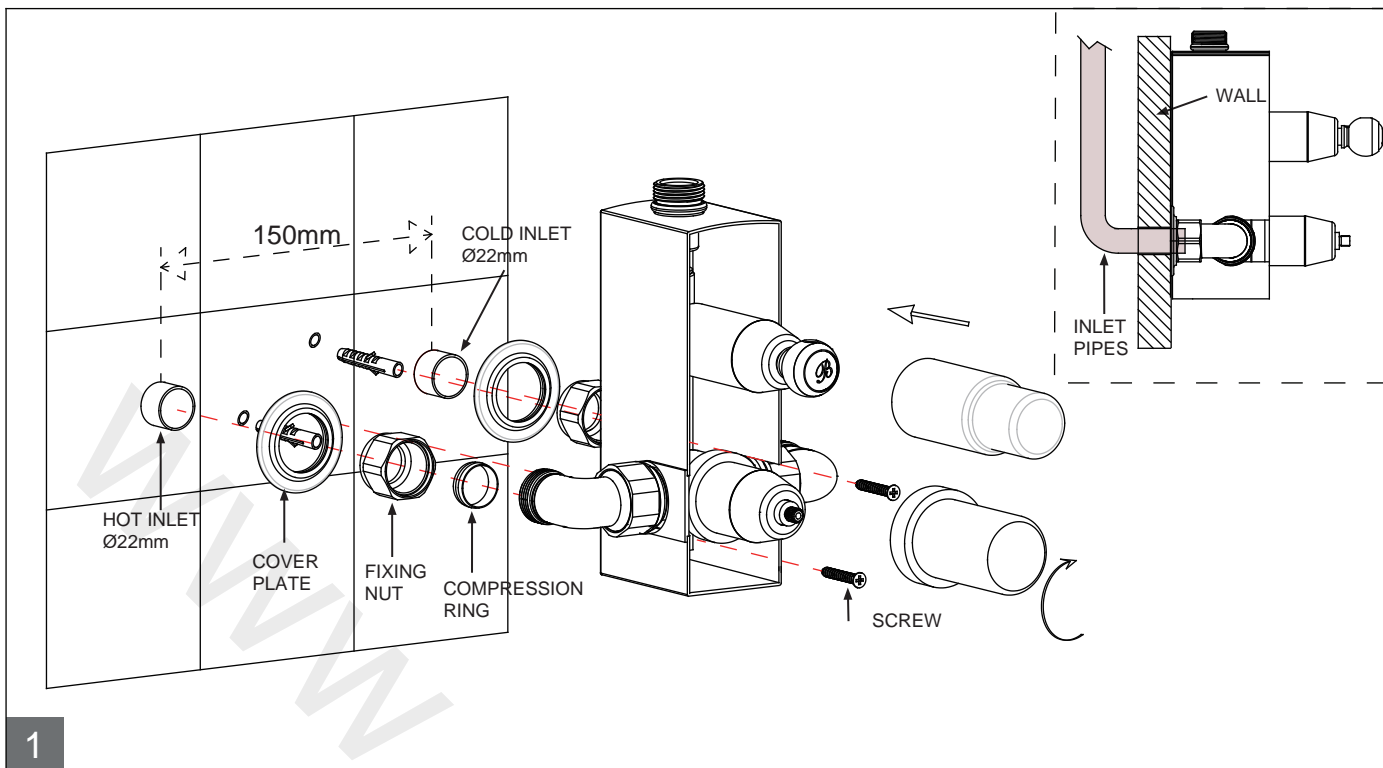

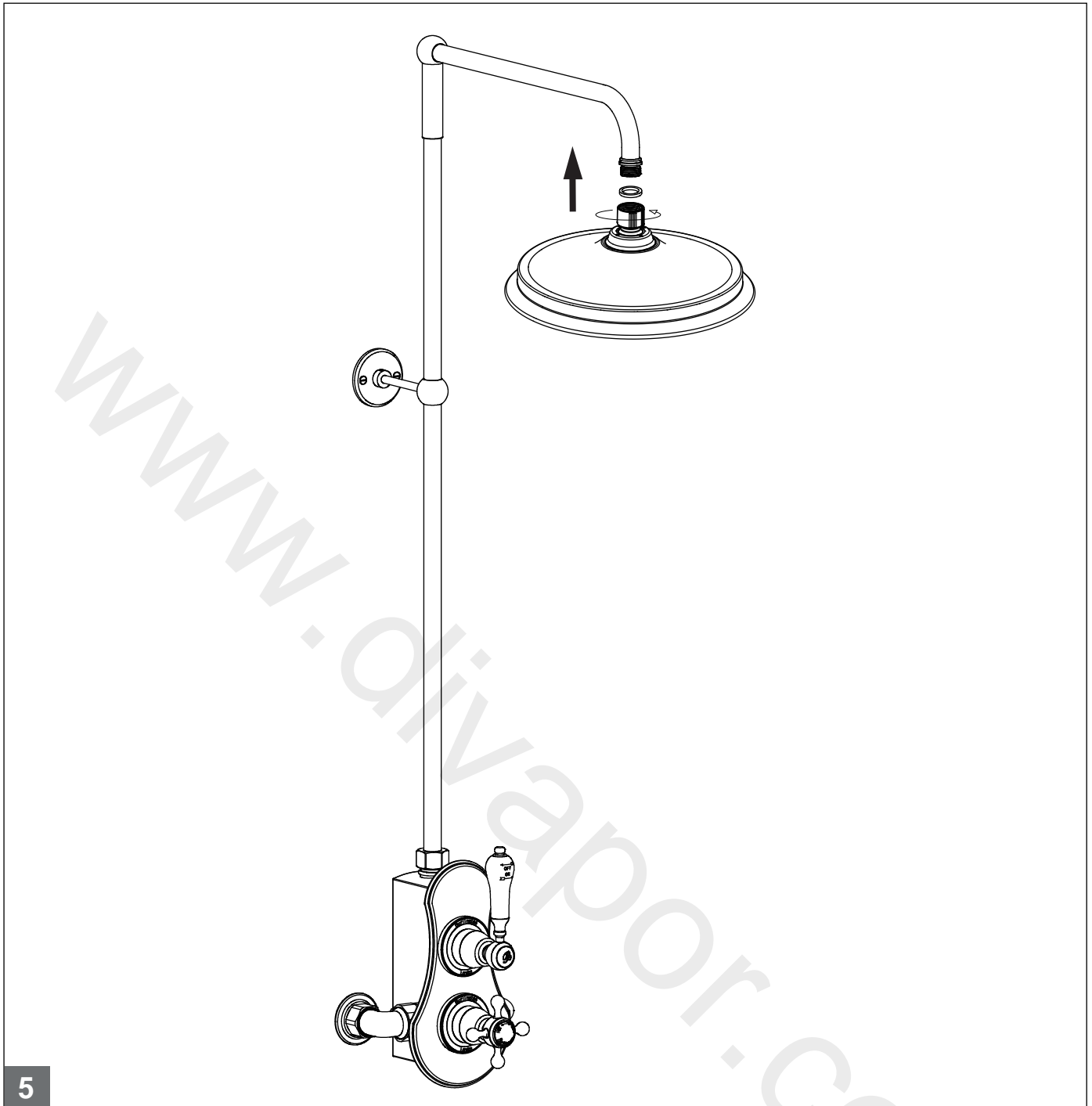

5

The valve should be installed in accordance with the water bye-laws. For further details refer to the latest copy of Water Bye-laws guide or your local water authority.

Note: Please check for any hidden pipes and cables before drilling holes in the wall.

The fitting of isolation valves is required as close as is practicable to both hot and cold water supply inlets.

1. a: Determine the final installation position and installation height as per the dimension drawing on page 2.
- b: Prepare the water supply pipes (hot on the left and cold on the right) at the identified height with a width of 150mm centers. Make the ends of pipes 20-25mm out from the face of wall.
- c: Put the shower valve housing against the wall, mark the position of the 2 fixing holes following the housing holes position.
- d: Drill 2X8mm holes on the wall to a depth of 40mm and insert wall plugs.
- e: Push the shower valve over each pipe. Slide the cover plates against the wall, join inlet elbows to hot/cold pipe from the wall.
- f: Finally mount the shower valve onto the wall by screwing into the 2 screws.
2. Install the riser into the shower valve (see Fig 2).
3. Install the wall bracket onto the wall to hold the riser, also push the back plate into position (see Fig 3).
4. Insert the shower arm into the riser, mount the handles onto the valve body (see Fig 4).
5. Put the shower head onto the shower arm (see Fig 5).

## Operation

1. Turn the water flow control handle to increase/decrease the water flow and turn on/off.
2. Turn the temperature control handle to increase/decrease the water temperature.

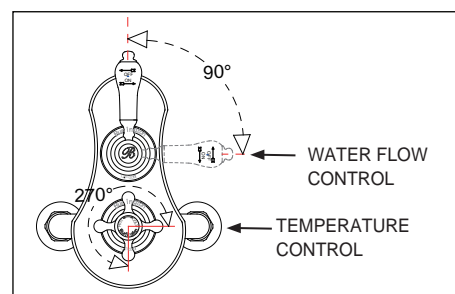

## Temperature Setting

The temperature control handles on this product are factory set and should require no adjustment.

However, if for any reason the handles and/or the cartridge is removed it is important the following procedure is followed.

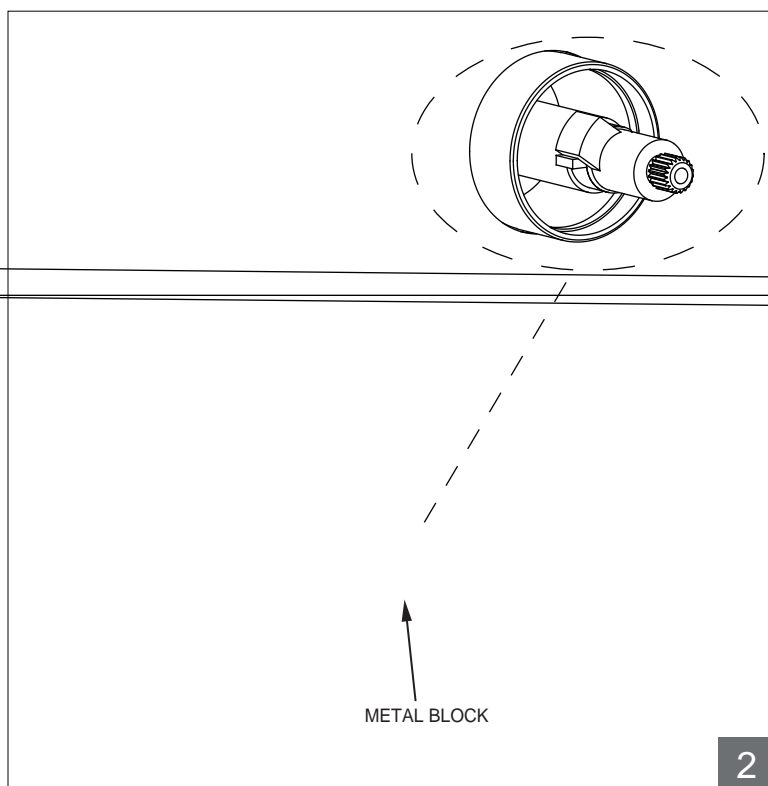
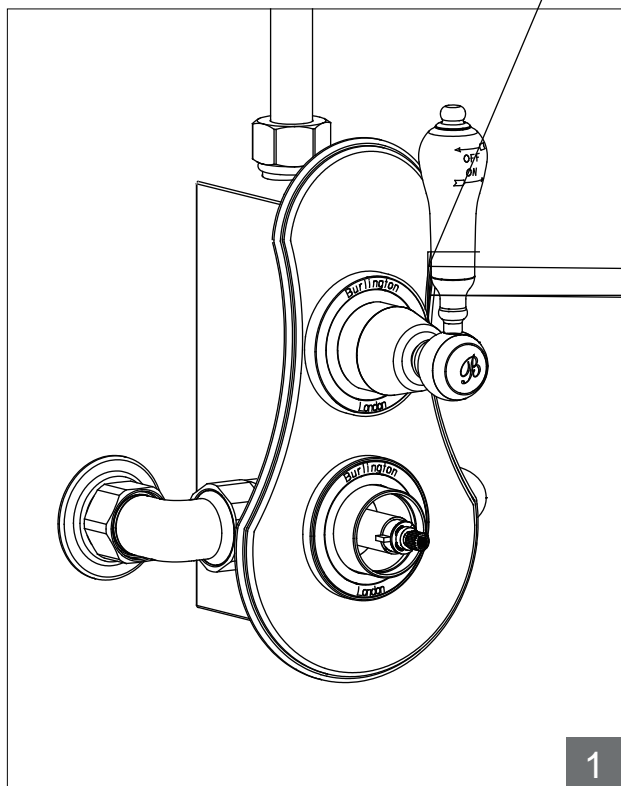

- 1 ) Remove the temperature control handle, metal block as the page 2 diagram.
- 2 ) Rotate the exposed thermostatic spindle (clockwise for cold, and anti-clockwise for hot), until the maximum desired showering temperature is set.  
The suggested maximum "pre-set" temperature is 42°C (see Fig 1).
- 3 ) Without any move at the spindle, replace the metal block so that limit stop up to the right hand side of the limit stop on the cartridge (see Fig 2).
- 4 ) Then refit the temperature control handle.

## Maintenance

\* After a long time usage of thermostatic valve, there will be some waste debris from the water pipe on and around the check valve or thermostatic cartridge, which will affect the flow and sensitivity of automatical temperature adjustment. Please take out the thermostatic cartridge, and clean the cartridge strainer.

\* To avoid damage, please remove all chrome parts before any maintenance takes place.

### Maintenance (Check valve)

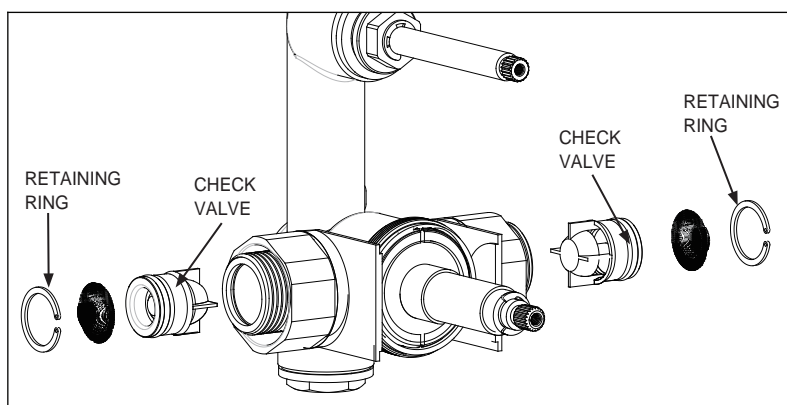

- A) Cutoff the Hot & Cold supply at the isolating valve.
- B) Disconnect the hot & cold water supply from the valve.
- C) Use a suitable screwdriver to remove the fixing screws.
- D) Fetch out the valve, and take out the check valve.
- E) Clean the check valve with clean running water, dry and lightly grease the seals. (only use silicone grease)
- F) Put back all of the parts in sequence.

