

nabis

Mono Pull out Kitchen Mixers

Instructions

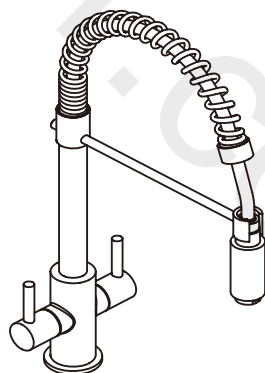
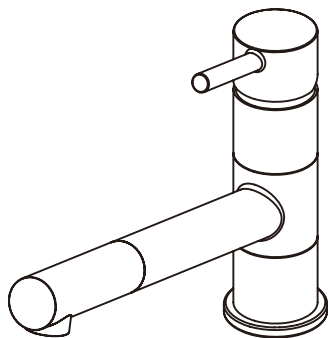
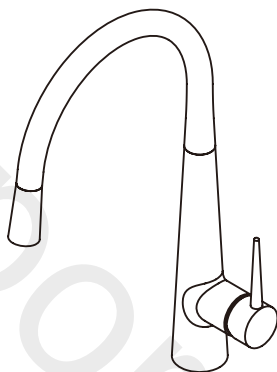
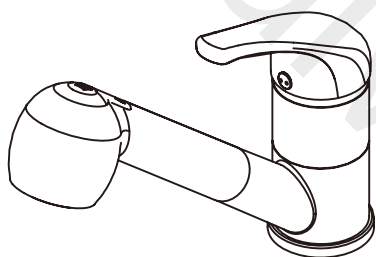

Product code:

B08922 B08924 B08929 B08930

Please keep these instructions for future reference.

Water Regulations Requirements

It is important to ensure that the water supplies to your taps and mixers are connected in accordance with the Water Regulations and good plumbing practice.

It is Wolseley's recommendation and good plumbing practice that the supplies of hot and cold water to the products should be equal (balanced) pressures in order to provide a consistent flow. Supplies should be from a common source.

Please note: if a pump is to be installed to boost gravity supplies please refer to the pump manufactures instructions.

The hot and cold inlets for any of the products are hot on the left and cold on the right when viewed from the front of the fitting. It is our recommendation and good plumbing practice that a service valve also should be installed up stream in the inlet supply lines.

Pipe Connections

IMPORTANT. Before making any inlet pipe connections all supplies MUST be thoroughly flushed to remove any debris.

Failure to do so could result in damage or low flow from the fitting.

General Installation Notes

- Care must be taken during installation to prevent any risk of damage to the product or injury to installer.
- Installation must be carried out by a qualified and competent person and in accordance with the instructions supplied.
- Installations must comply with all Local and National Water Authority Regulations and Building/Plumbing Regulations.
- Ensure that you have read and understood all sections of this manual before installation.

Water Supply Pressures

All fittings have been designed to function under the following conditions:

- Minimum supply pressure: 1.0 bar
- Maximum supply pressure: 5.0 bar

Generous flow rates are achieved at pressures as low as 1.0bar. At high pressures it maybe necessary to reduce excessive flow rates by fitting stop or servicing valves in the supply line before the mixer or tap. These stop valves facilitate ease of maintenance should it be necessary.

Warning from your Water Supplier

It could be a criminal offence to use this tap with a mains water supply drawn directly from the supply pipe.

(The supply pipe is the one which brings the water supply into your home and is directly connected to the public water main).

This tap has an outlet on a flexible hose which, if left immersed in water, could result in contaminated water being drawn back into the pipework if the supply pressure dropped. To prevent contamination of drinking water in the premises and in the water main, and to comply with the legal requirements of the UK plumbing regulations and byelaws*, both hot and cold water supplied to this tap must come from a storage cistern.

If the distributing pipes feeding this tap from the storage cistern have other outlets connected to them, the outlet of this tap must be lower than any of those other outlets.

If installed as a tap which is used for drawing water for drinking, and the quality of water from the storage cistern does not meet the standards for drinking water, a separate tap supplied with wholesome water must be provided for drinking purposes.

For further information, contact the Water Regulations department of your local Water Supplier (see the WRAS website www.wras.co.uk for details) or the Water Regulations Advisory Scheme by e-mail (info@wras.co.uk) or telephone: +44 (0) 333 207 9030.

* The Water Supply (Water Fittings) Regulations 1999 (England and Wales), The Water Supply (Water Fittings) (Scotland) Byelaws 2014 or The Water Supply (Water Fittings) Regulations (Northern Ireland) 2009.

Installation Requirements

Flexible Connecting Pipes

Please ensure flexible pipes are connected to the household pipework with extra care to avoid the flexi pipes are not kinked, twist or bent sharply.

Below are recommended ways to fit the flexible pipes during tap installation. Failure to follow the below recommended guidelines may damage the flexible pipes or poor taps performance.

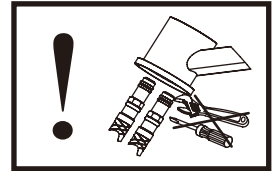
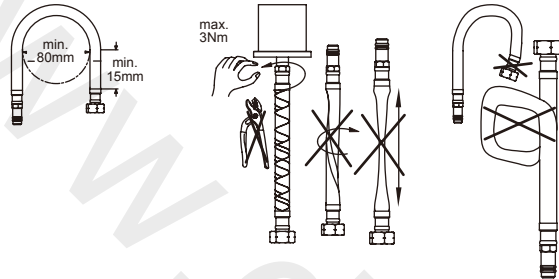

Single lever pull-out kitchen mixer

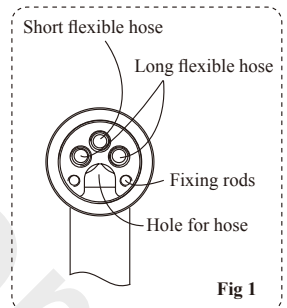
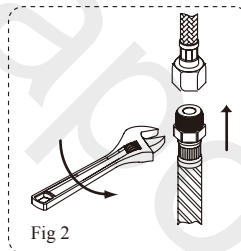
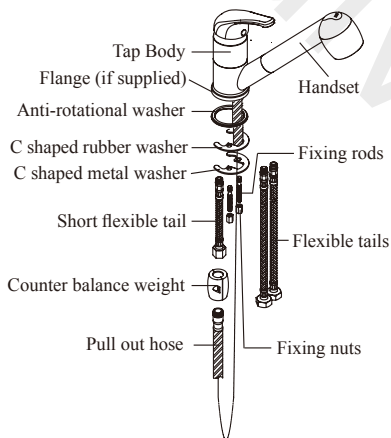

1. Identify all components and check for completeness, particularly before commencing installation.
2. Screw fixing rods to tap body and tighten it.
3. Ensuring that the anti-rotational washer is fitted between the flange and the sink. Pull out hose must be through the hole of the anti-rotational washer. If the flange and tap body are separate in the pack, need to fit flange to tap body first.
4. Screw 2x flexible tails and short flexible hose into tap body by hand, do not over tighten. See Fig 1.
5. Locate the tap assembly down through the tap hole in sink.
6. Slide the C shaped rubber washer and the C shaped metal washer onto the fixing rods up to the underside of the sink. To secure the mixer in place tighten the fixing nuts onto the fixing rods until they fully tightened against the C shaped metal washer.
A suitable spanner may be required to fully tighten the fixing nuts.
7. Connect Pull out hose to short flexible hose using a spanner. See Fig 2.
8. Fit counter balance weight to pull-out hose in the position, Connect the flexible tails to the hot and cold water supplies.
9. Turn on the mains water supply letting the water flow for a few minutes to flush through the system.
10. Check all joints and connections for any leaks.

Single lever pull-out kitchen mixer

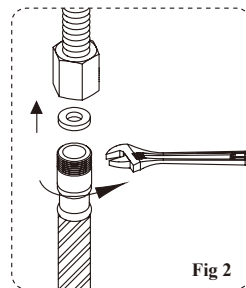
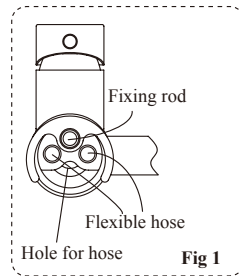
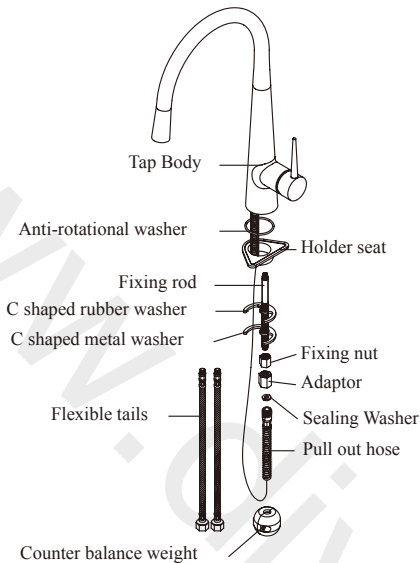

1. Identify all components and check for completeness, particularly before commencing installation.
2. Screw fixing rods to tap body and tighten it. See Fig 1.
3. Ensuring that the anti-rotational washer is fitted between the tap body and the sink. Pull out hose must be through the hole of the anti-rotational washer.
4. Screw 2x flexible tails into the tap body. Do not over tighten. See Fig 1.
5. Locate the tap assembly down through the tap hole in sink.
6. Slide the holder seat, C shaped rubber washer and the C shaped metal washer onto the fixing rod up to the underside of the sink. To secure the mixer in place tighten the fixing nut onto the fixing rod until they fully tightened against the C shaped metal washer. A suitable spanner may be required to fully tighten the fixing nuts.
7. Ensure that the sealing washer is fitted to the adaptor.
8. Connect pull out hose to the adaptor using a spanner. See Fig 2.
9. Fit counter balance weight to pull out hose in the position.
10. Connect the flexible tails to the hot and cold water supplies.
11. Turn on the mains water supply letting the water flow for a few minutes to flush through the system.
12. Check all joints and connections for any leaks.

Single lever pull-out kitchen mixer

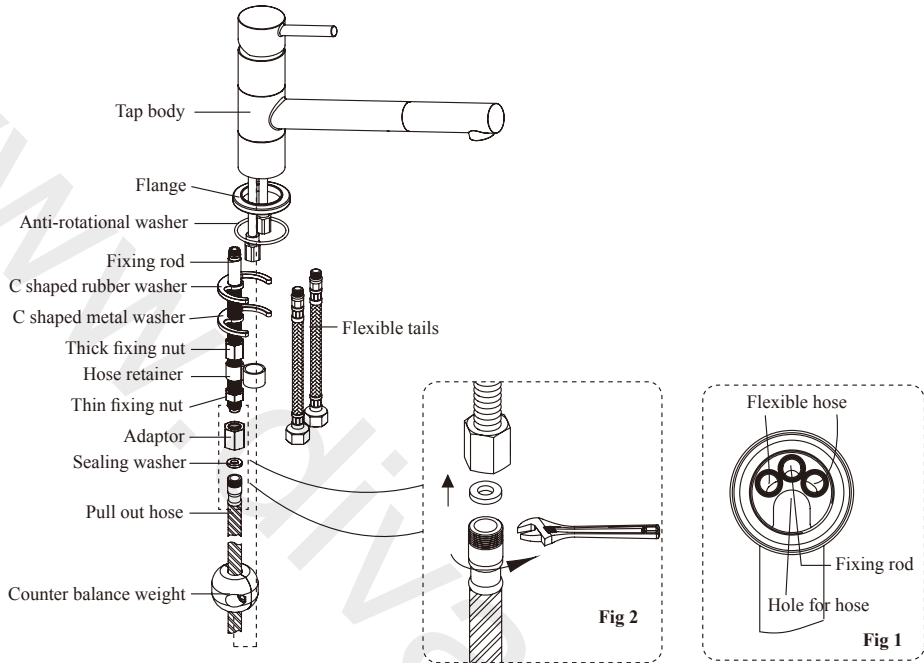

1. Identify all components and check for completeness, particularly before commencing installation.
2. Screw fixing rod to tap body and tighten it. See Fig 1.
3. Ensuring that the anti-rotational washer is fitted the flange, then fit flange to tap body. Pull out hose must be through the hole of the anti-rotational washer and the flange.
4. Screw 2x flexible tails into the tap body. Do not over tighten. See Fig 1.
5. Locate the tap assembly down through the tap hole in sink.
6. Slide the C shaped rubber washer and the C shaped metal washer onto the fixing rod up to the underside of the sink. To secure the mixer in place tighten the thick fixing nut onto the fixing rod until they fully tightened against the C shaped metal washer. A suitable spanner may be required to fully tighten the fixing nuts.
7. Fit hose retainer to pull out hose, slide hose retainer to the fixing stud, secure this into position using the thin fixing nut.
8. Fit adaptor to fixing stud and tighten.
9. Ensure that the sealing washer is fitted to the adaptor.
10. Connect pull out hose to the adaptor using a spanner. See Fig 2.
11. Fit counter balance weight to pull out hose in the position.
12. Connect the flexible tails to the hot and cold water supplies.
13. Turn on the mains water supply letting the water flow for a few minutes to flush through the system.
14. Check all joints and connections for any leaks.

Mono pull-out kitchen mixer

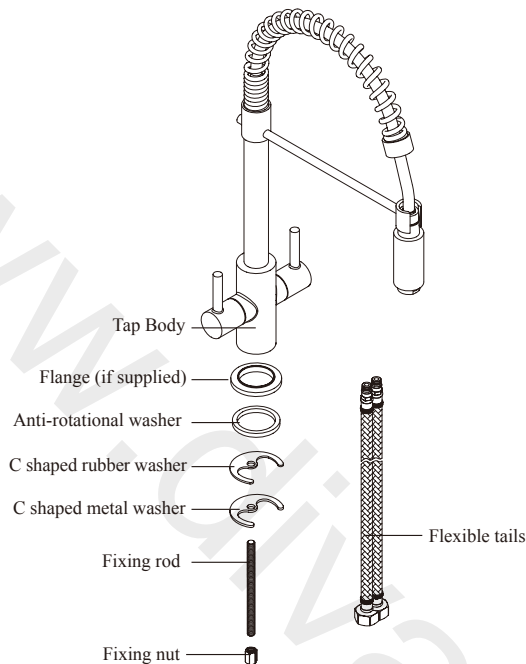

1. Identify all components and check for completeness, particularly before commencing installation.
2. Screw fixing rod to tap body and tighten it.
3. Fit flange to tap body, ensuring that the anti-rotational washer is fitted between the flange and the sink. if the flange is not supplied, fit anti-rotational washer directly to the tap body.
4. Screw 2x flexible tails into tap body, do not over tighten.
5. Locate the tap assembly down through the tap hole in sink.
6. Slide the C shaped rubber washer and the C shaped metal washer onto the fixing rod up to the underside of the sink. To secure the mixer in place tighten the fixing nut onto the fixing rods until they fully tightened against the C shaped metal washer.
A suitable spanner may be required to fully tighten the fixing nuts.
7. Connect the flexible tails to the hot and cold water supplies.
8. Turn on the mains water supply letting the water flow for a few minutes to flush through the system.
9. Check all joints and connections for any leaks.

Component Diagrams

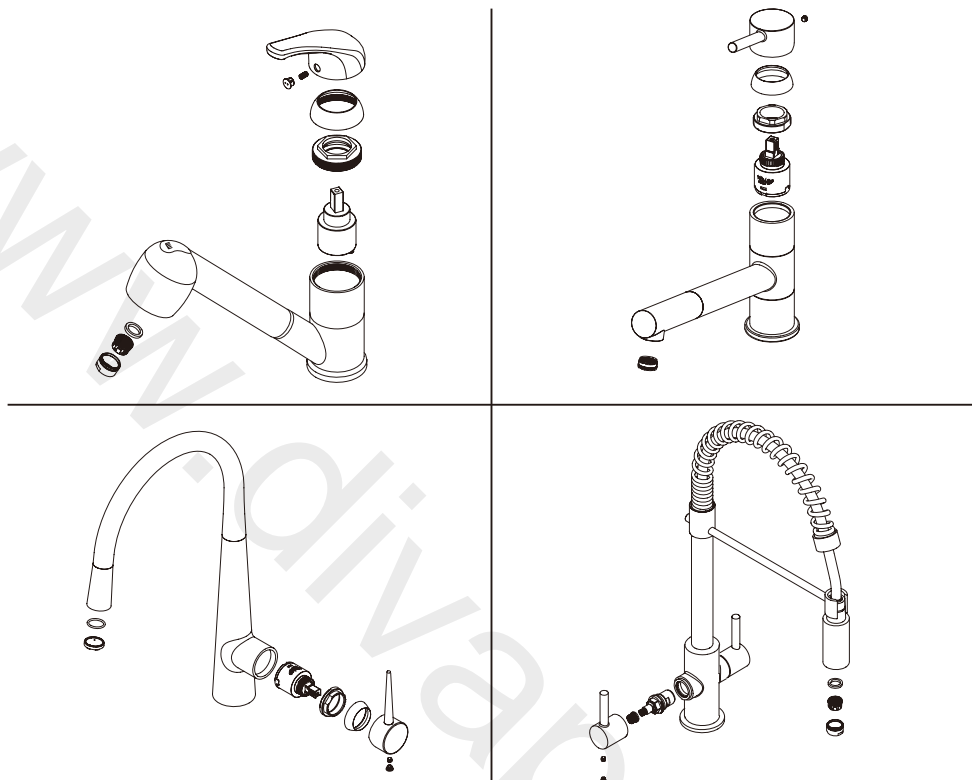

Care & Maintenance

To maintain the surface finishes, simply wipe occasionally with a mild detergent on a soft damp cloth. Dry using a soft cloth, never use abrasive cleaners or chemical household cleaners, and avoid contact with concentrated bleach.

Nabis products are manufactured to the highest of standards and should require little or no maintenance. In the unlikely event of any spare part requirements, please contact our telephone helpline number.

Telephone Helpline

Should you require any technical help in association with your Nabis product please call 0344 292 7060 with your query.

Warranty: 5 Years

For detail warranty information, please visit our website: www.wolseley.co.uk

Address:

Wolseley
CV34 6DY

Website:
www.wolseley.co.uk

