

Product features:

- Metal construction throughout
- Quarter turn handle action for precise flow control
- Custom designed for lower range pressures
- Supplied complete with flexible tail pipes for fast simple fitting
- Swivel spout for maximum flexibility

Packaged properties:

Box length (mm): 415 Box depth(mm): 95
Box width(mm): 180 Boxed weight (Kg): 2.65

Includes pop up waste?: No

Additional comments:

Product dimensions:

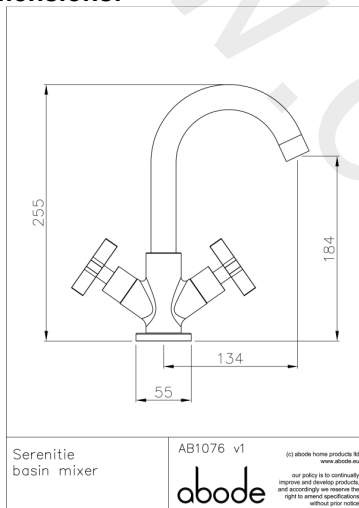

- Product mounted where: Surface
- Recommended hole size: 32 mm
- Overall Height / projection: 255 mm
- Exit reach: 134 mm
- Exit height: 184 mm
- Base size: 55 mm
- Inlet centre distance(s): n/a mm
- Min. fitting depth required: n/a mm 50 mm
- Max. surface depth:

Product flow characteristics:

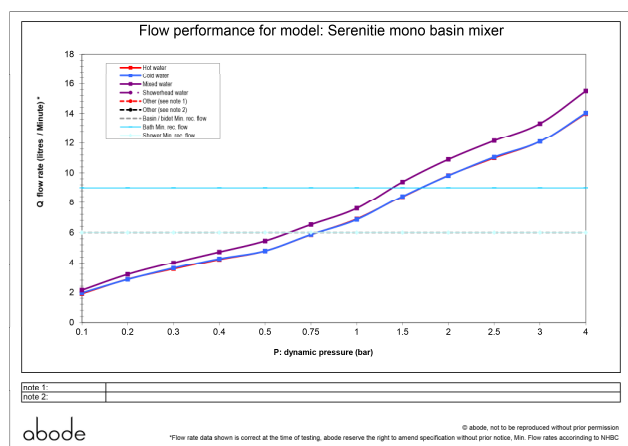

- Min / Max water pressure (bar): 0.60* / 5.00
- Part G max. mixed flow rate at 3 bar (l/m): 13.33
- Inlet connection type / length: Flexible / 360 mm
- Inlet (plumbing connection) / outlet size: 1/2" Male / M10
- Product flow characteristics: Single Flow
Non return valve(s) supplied or position: No
- Aerator type: Laminar Cyan/Grey
- Control valve type: 1/2" QT CD (tbc)
- Includes output diverter?: N/A
- Inlet meshed particle filters included: N/A
- Shower hose type / length: N/A / N/A

Warranty Summary (full details available on request):

- Materials and workmanship defects warranted for 5 years
- Valves and working parts warranted for 5 years
- Surface warranty defects warranted for 1 year
- O-rings, hoses & gaskets warranted for 1 year

Care instructions:

- Clean the mixers and showers regularly as required, using soap, do not use any other cleaners.
- Regular cleaning will prevent the build-up of lime scale and dirt
- After cleaning rinse thoroughly with clean water to remove any cleaner residue
- Residues of liquid soaps, shampoos and shower foams can also cause damage, so rinse with clean water after using, avoid contact with any abrasives