

Produced since: **Nov. 2015**

Bath Filler rim-mounted
with accessories

chrome **A6591AA**

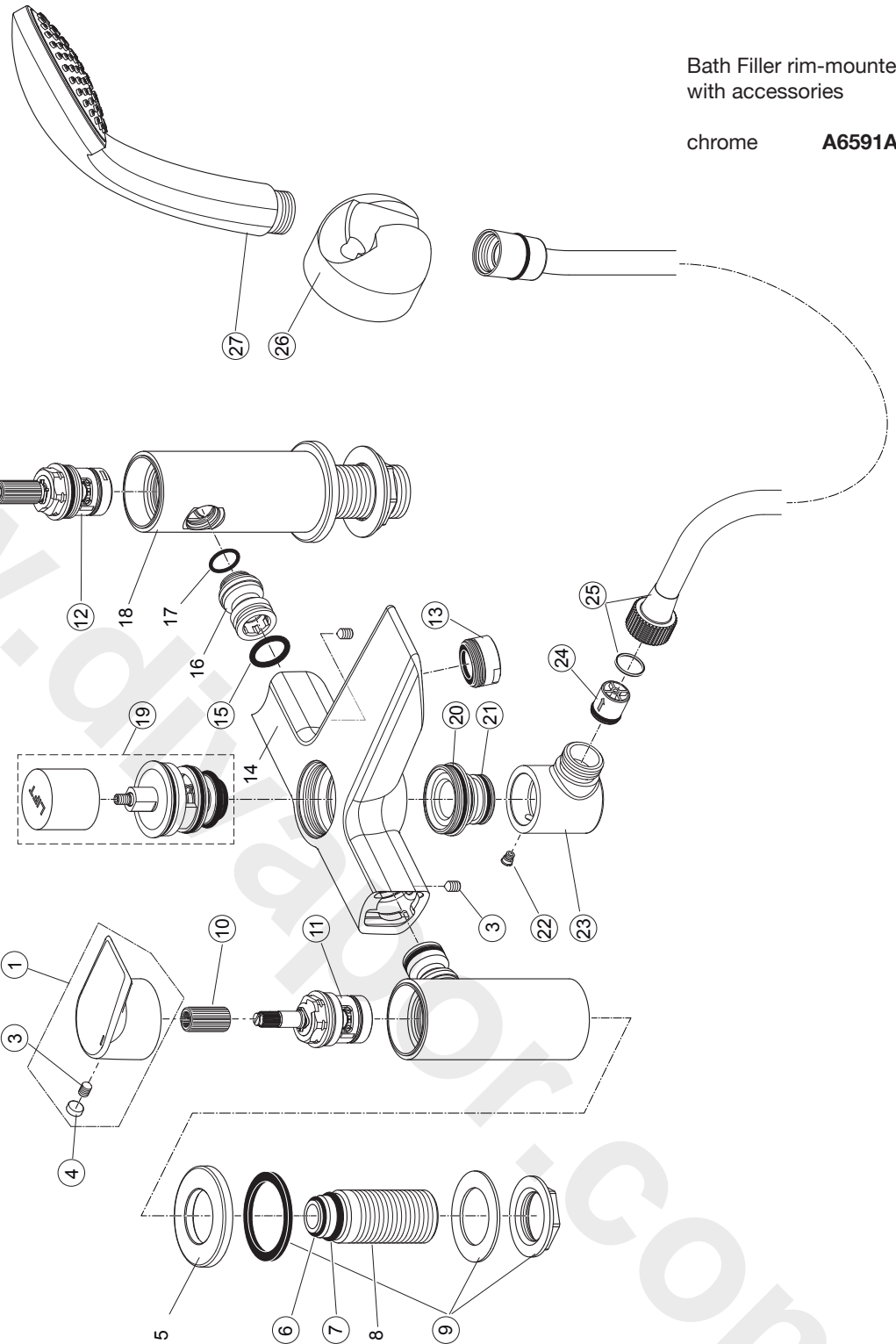

Pos.	Description	Part-Number	Qty.	Pos.	Description	Part-Number	Qty.
1	Handle cpl. red marked	A 861 064 AA	1 Set	15	O - Ring Ø 16 x 2,5	A 961 326 NU	2 pcs
2	Handle cpl. blue marked	A 861 065 AA	1 Set	16	Connector nipple		
3	Screw M5 x 6 DIN 914	F 961 001 NU	1 pcs	17	O - Ring Ø 13 x 1,5		
4	Handle cap	B 960 583 NU	1 pcs	18	Body (Cartridge)		
5	Escutcheon			19	Diverter cpl.	B 961 172 AA	1 Set
6	O - Ring Ø 31,47 x 1,78	A 961 640 NU	2 pcs	20	O - Ring Ø 30 x 2	A 860 569 NU	1 pcs
7	O - Ring Ø 19 x 2,50	A 860 187 NU	1 pcs	21	O - Ring Ø 20 x 2	A 860 395 NU	1 pcs
8	Connector G3/4"			22	Screw M5x5.5	A 960 058 NU	1 pcs
9	Fixation Kit	B 960 471 NU	1 Set	23	Elbow for diverter	B 9611 73 AA	1 pcs
10	Handle adaptor	N 042 677 NU	2 pcs	24	Non return valve	A 962 594 NU	2 pcs
11	Cartridge clsd. anti-clockw.	A 961 010 NU	1 pcs	25	Shower hose 1800mm	A 963 173 NU	1 pcs
12	Cartridge closed clockwise	A 960 462 NU	1 pcs	26	Handshower holder	B 9467 AA	1 pcs
13	Aerator M24x1	A 961 625 AA	1 pcs	27	Handspray 1F Ø80mm	B 9400 AA	1 pcs
14	Body (Bath filler)						