

## AXOR Edge

**3-hole basin mixer for concealed installation wall-mounted with spout 190 mm - diamond cut 2 ticks**

Finish: **Chrome** Article Number: **46062009**



### product features

- consists of: 3-hole basin mixer, waste set
- projection: 190 mm
- handle variant: lever handle
- spray type: normal spray
- maximum flow rate at 3 bar: 3 l/min
- ceramic valves hot/cold 90°
- suitable for continuous flow water heaters
- push-open waste set G 1¼
- material waste set: metal
- connection type: basic set
- connection dimension: DN15

### Technology



### Product image



### Scale drawing

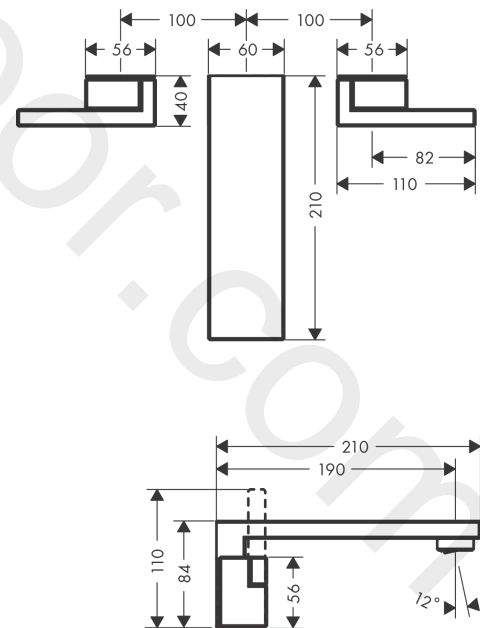

## AXOR Edge

3-hole basin mixer for concealed installation wall-mounted with spout 190 mm - diamond cut 2 ticks

Finish: **Chrome** Article Number: **46062009**



### Flowchart

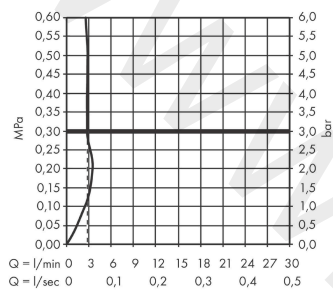

**AXOR Edge**  
**3-hole basin mixer for concealed installation wall-mounted with spout 190 mm - diamond cut 2**  
**ticks**  
 Finish: **Chrome** Article Number: **46062009**



## Exploded Drawing

Year of production: >04/20

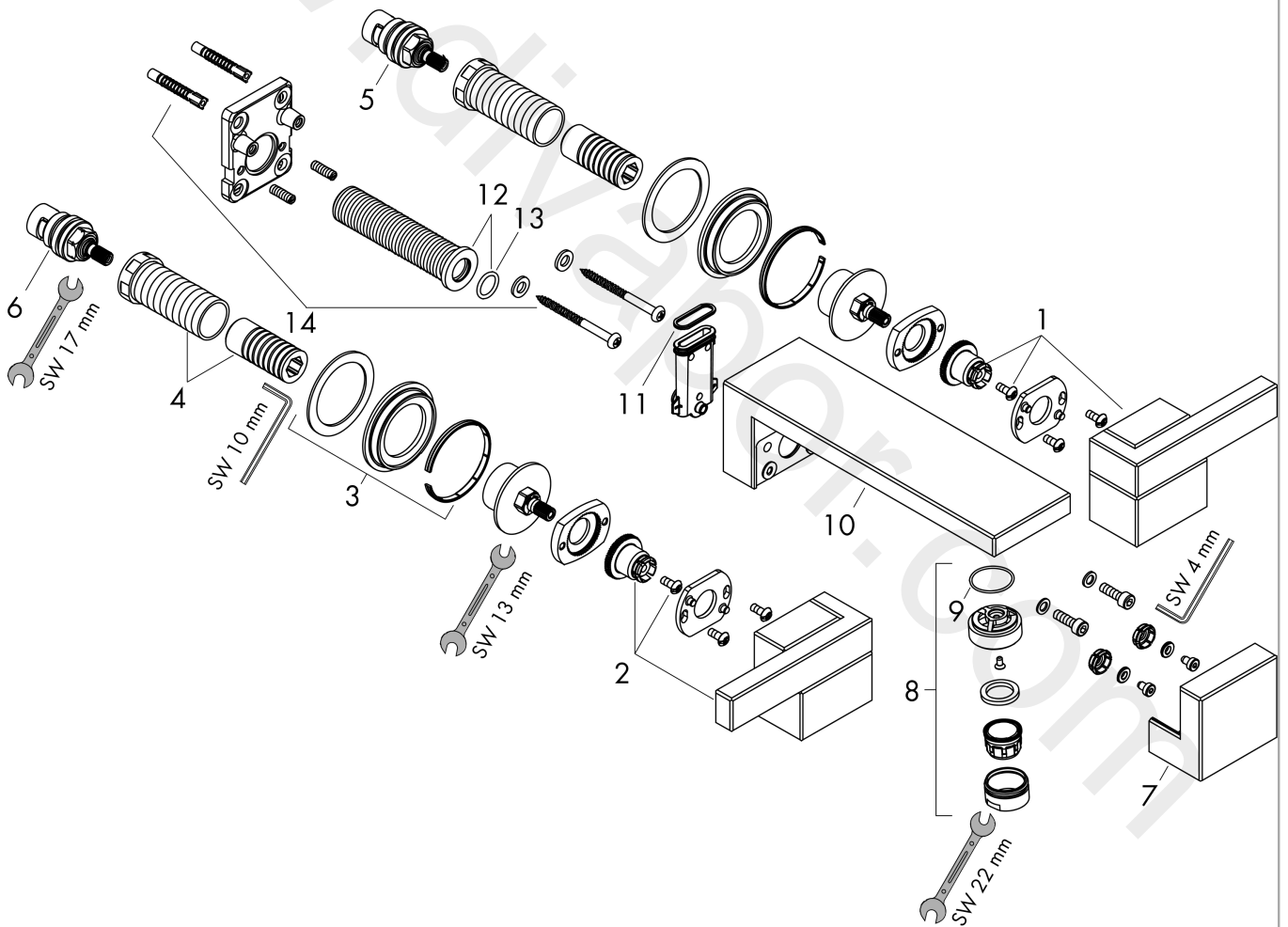

## AXOR Edge

**3-hole basin mixer for concealed installation wall-mounted with spout 190 mm - diamond cut 2 ticks**

Finish: **Chrome** Article Number: **46062009**



### Spare part list

Year of production: >04/20

Pos.		Article Number	Price	PU
1	handle for cold water	93621000	£ 830,00	1
2	handle for hot water	93622000	£ 830,00	1
3	escutcheon	93510000	£ 51,00	1
4	connecting thread G½	93625000	£ 64,00	1
5	shut off unit left closing	96351000	£ 51,00	1
6	shut off unit right closing	96350000	£ 51,00	1
7	cover	93627000	£ 585,00	1
8	aerator M24x1 (3,5 l/min)	92508000	£ 20,50	1
9	O-ring 22x1,2	98397000	-	1
10	spout cpl.	93626000	£ 830,00	1
11	O-ring 18x2	98181000	£ 6,10	1
12	fixing set	96393000	£ 35,00	1
13	O-ring 12x2	98214000	£ 3,30	1
14	mounting set	96179000	£ 13,30	1
a	push-open waste set	51300000	£ 94,00	1
b	extension 25 mm	95413000	£ 79,00	1
c	extension 25 mm	96259000	£ 79,00	1