

36 427 970



- rotary diverter with volume control and shut-off function
- cover plate Ø 150 mm
- temperature control handle with safety limit stop at 38°C
- hot water temperature limiter, can be preset
- WRAS: 1906098

Fits: TARA, VAIA, META

	Matte White	36 427 970-10
	Chrome	36 427 970-00
	Brushed Platinum	36 427 970-06
	Platinum	36 427 970-08
	Dark Chrome	36 427 970-19
	Brushed Durabronze (23kt Gold)	36 427 970-28
	Matte Black	36 427 970-33
	Brushed Champagne (22kt Gold)	36 427 970-46
	Champagne (22kt Gold)	36 427 970-47
	Brushed Chrome	36 427 970-93
	Brushed Dark Platinum	36 427 970-99

Required miscellaneous



- Concealed thermostat**
- min. recess depth 80 mm
 - max. recess depth 136 mm

35 427 970 90

Required miscellaneous



- Concealed thermostat with built-in isolators**
- min. recess depth 80 mm
 - max. recess depth 136 mm

35 428 970 90

Recommended miscellaneous



- xGRID Attachment set for integrating in the dry wall construction**

12 340 970 90

Required miscellaneous



- xGRID Installation track 555 mm**

12 360 970 90

36 427 970

mm [inches]

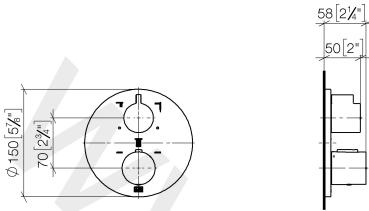

Flow rate chart

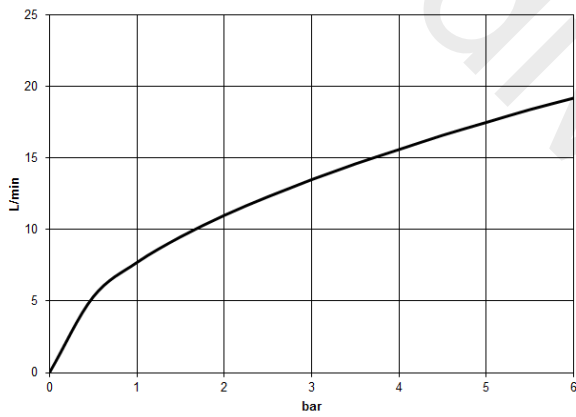

36 427 970

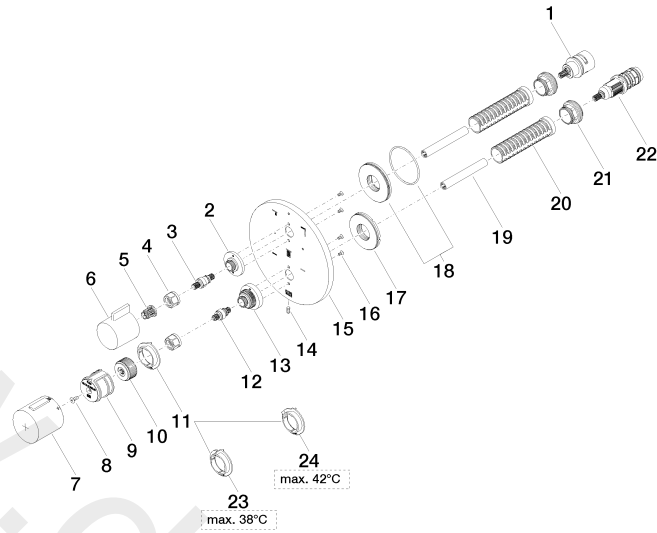

36 427 970

Spare parts list

No.	Item Number	Name	Quantity used	Delivery time
1	90 90 03 170 00 90	diverter	1	2
2	09 12 12 053-10	base	1	40
3	04 29 06 111 00-00	spindle	1	60
4	09 23 30 023 90	nut	2	2
5	90 12 12 002 00 90	fixing cap	1	2
6	09 20 67 006-10	handle	1	40
7	90 17 33 017 00-10	handle	1	40
8	09 30 30 124 90	screw	1	2
9	09 12 12 052 90	base	1	2
10	09 12 12 054 90	base	1	2
11	09 28 10 187 90	regulator	1	2
12	04 29 06 024 00-00	spindle	1	60
13	09 12 12 051-10	base	1	40
14	09 31 11 134 90	pin	1	2
15	09 11 02 269-10	plate	1	40
16	09 30 30 157 90	screw	4	2
17	09 30 01 296 90	disc	1	2
18	90 30 01 190 00 90	disc	1	2
19	09 23 01 124 90	sleeve	2	2
20	09 18 40 077 90	sleeve	2	2
21	09 24 04 257 90	nut	2	2
22	90 15 02 013 00 90	cartridge	1	2
23	09 28 10 188 90	regulator	1	2
24	09 28 10 189 90	regulator	1	2