

36 427 970



- rotary diverter with volume control and shut-off function
- cover plate Ø 150 mm
- temperature control handle with safety limit stop at 38°C
- hot water temperature limiter, can be preset
- WRAS: 1906098

Fits: TARA, VAIA, META

| | | |
|---|--------------------------------|---------------|
|  | Platinum | 36 427 970-08 |
|  | Chrome | 36 427 970-00 |
|  | Brushed Platinum | 36 427 970-06 |
|  | Matte White | 36 427 970-10 |
|  | Dark Chrome | 36 427 970-19 |
|  | Brushed Durabronze (23kt Gold) | 36 427 970-28 |
|  | Matte Black | 36 427 970-33 |
|  | Brushed Champagne (22kt Gold) | 36 427 970-46 |
|  | Champagne (22kt Gold) | 36 427 970-47 |
|  | Brushed Chrome | 36 427 970-93 |
|  | Brushed Dark Platinum | 36 427 970-99 |

Required miscellaneous



- Concealed thermostat**
- min. recess depth 80 mm
 - max. recess depth 136 mm

35 427 970 90

Required miscellaneous



- Concealed thermostat with built-in isolators**
- min. recess depth 80 mm
 - max. recess depth 136 mm

35 428 970 90

Recommended miscellaneous



- xGRID Attachment set for integrating in the dry wall construction**

12 340 970 90

Required miscellaneous



- xGRID Installation track 555 mm**

12 360 970 90

36 427 970

mm [inches]

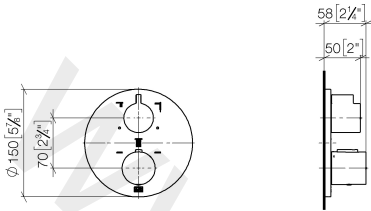

Flow rate chart

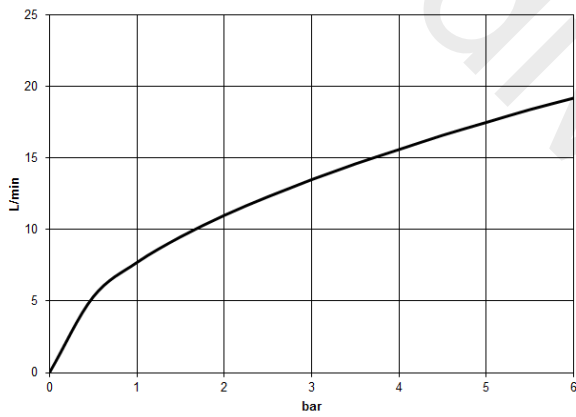

36 427 970

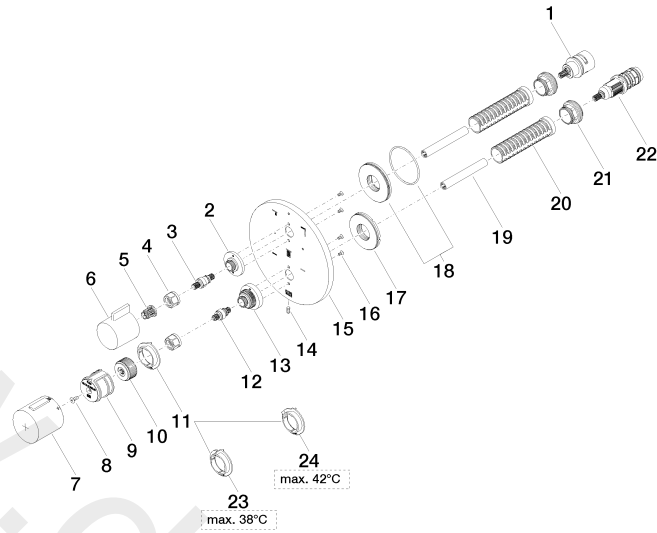

36 427 970

Spare parts list

| No. | Item Number | Name | Quantity used | Delivery time |
|-----|--------------------|------------|---------------|---------------|
| 1 | 90 90 03 170 00 90 | diverter | 1 | 2 |
| 2 | 09 12 12 053-08 | base | 1 | 20 |
| 3 | 04 29 06 111 00-00 | spindle | 1 | 60 |
| 4 | 09 23 30 023 90 | nut | 2 | 2 |
| 5 | 90 12 12 002 00 90 | fixing cap | 1 | 2 |
| 6 | 09 20 67 006-08 | handle | 1 | 20 |
| 7 | 90 17 33 017 00-08 | handle | 1 | 20 |
| 8 | 09 30 30 124 90 | screw | 1 | 2 |
| 9 | 09 12 12 052 90 | base | 1 | 2 |
| 10 | 09 12 12 054 90 | base | 1 | 2 |
| 11 | 09 28 10 187 90 | regulator | 1 | 2 |
| 12 | 04 29 06 024 00-00 | spindle | 1 | 60 |
| 13 | 09 12 12 051-08 | base | 1 | 20 |
| 14 | 09 31 11 134 90 | pin | 1 | 2 |
| 15 | 09 11 02 269-08 | plate | 1 | 20 |
| 16 | 09 30 30 157 90 | screw | 4 | 2 |
| 17 | 09 30 01 296 90 | disc | 1 | 2 |
| 18 | 90 30 01 190 00 90 | disc | 1 | 2 |
| 19 | 09 23 01 124 90 | sleeve | 2 | 2 |
| 20 | 09 18 40 077 90 | sleeve | 2 | 2 |
| 21 | 09 24 04 257 90 | nut | 2 | 2 |
| 22 | 90 15 02 013 00 90 | cartridge | 1 | 2 |
| 23 | 09 28 10 188 90 | regulator | 1 | 2 |
| 24 | 09 28 10 189 90 | regulator | 1 | 2 |