

36 426 892



- rotary diverter with volume control and shut-off function
- cover plate Ø 150 mm
- temperature control handle with safety limit stop at 38°C
- hot water temperature limiter, can be preset

	Brushed Platinum	36 426 892-06
	Chrome	36 426 892-00
	Platinum	36 426 892-08
	Matte White	36 426 892-10
	Dark Chrome	36 426 892-19
	Brushed Durabrass (23kt Gold)	36 426 892-28
	Matte Black	36 426 892-33
	Brushed Champagne (22kt Gold)	36 426 892-46
	Champagne (22kt Gold)	36 426 892-47
	Brushed Chrome	36 426 892-93
	Brushed Dark Platinum	36 426 892-99

Required miscellaneous



**Concealed thermostat with built-in isolators** 35 426 970 90  
 •min. recess depth 80 mm  
 •max. recess depth 136 mm

Required miscellaneous



**Concealed thermostat** 35 425 970 90  
 •min. recess depth 80 mm  
 •max. recess depth 136 mm

Required miscellaneous



**Drybox Concealed thermostat** 39 426 970 90

Required miscellaneous



**xGRID Installation track 555 mm** 12 360 970 90

Required miscellaneous



**Concealed thermostat with built-in isolators** 35 426 970 90  
 •min. recess depth 80 mm  
 •max. recess depth 136 mm

Required miscellaneous



**Drybox Concealed thermostat** 39 426 970 90

Recommended miscellaneous



**xGRID Attachment set for integrating in the dry wall construction** 12 340 970 90

36 426 892

mm [inches]

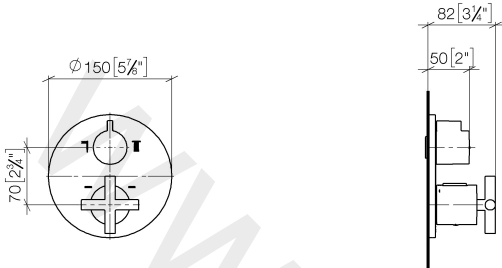

Flow rate chart

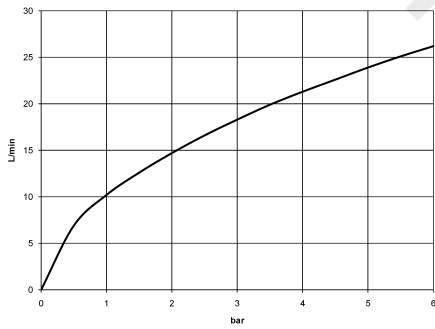

36 426 892

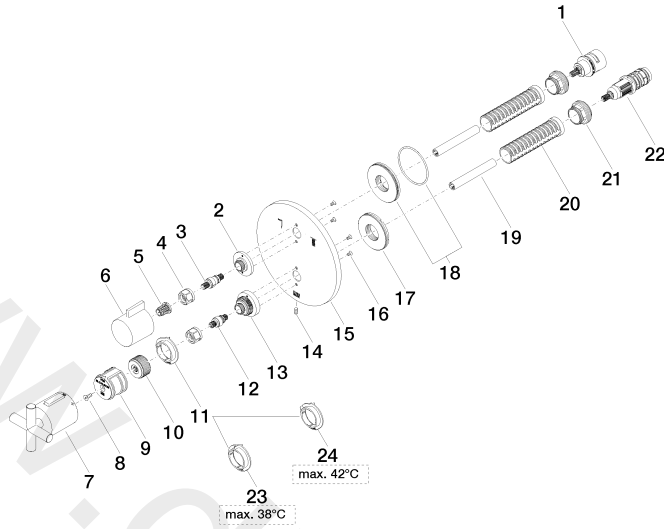

36 426 892

Spare parts list

No.	Item Number	Name	Quantity used	Delivery time
1	90 90 03 163 00 90	diverter	1	2
2	09 12 12 053-06	base	1	10
3	04 29 06 111 00-00	spindle	1	60
4	09 23 30 023 90	nut	2	2
5	90 12 12 002 00 90	fixing cap	1	2
6	09 20 67 006-06	handle	1	10
7	90 17 33 022 00-06	handle	1	10
8	09 30 30 124 90	screw	1	2
9	09 12 12 052 90	base	1	2
10	09 12 12 054 90	base	1	2
11	09 28 10 187 90	regulator	1	2
12	04 29 06 024 00-00	spindle	1	60
13	09 12 12 051-06	base	1	10
14	09 31 11 134 90	pin	1	2
15	09 11 02 243-06	plate	1	10
16	09 30 30 157 90	screw	4	2
17	09 30 01 296 90	disc	1	2
18	90 30 01 190 00 90	disc	1	2
19	09 23 01 124 90	sleeve	2	2
20	09 18 40 077 90	sleeve	2	2
21	09 24 04 257 90	nut	2	2
22	90 15 02 013 00 90	cartridge	1	2
23	09 28 10 188 90	regulator	1	2
24	09 28 10 189 90	regulator	1	2