

## Focus

### Single lever shower mixer for exposed installation with 2 flow rates

Finish: **Chrome** Article Number: **31968000**



## Description

### product features

- 1 function
- centre distance:  $150 \pm 12$  mm
- maximum flow rate at 3 bar: 22 l/min
- ceramic cartridge with Eco handle position for a reduced flowrate by up to 50%
- temperature limitation adjustable
- non-return valve
- with silencer
- hose connection DN15
- connection dimension: DN15
- connection type: s-shaped connections

## Article Details

Price excl. VAT

133,33 £

## Technology



## Certificates / Sustainability



## Product image



## Scale drawing

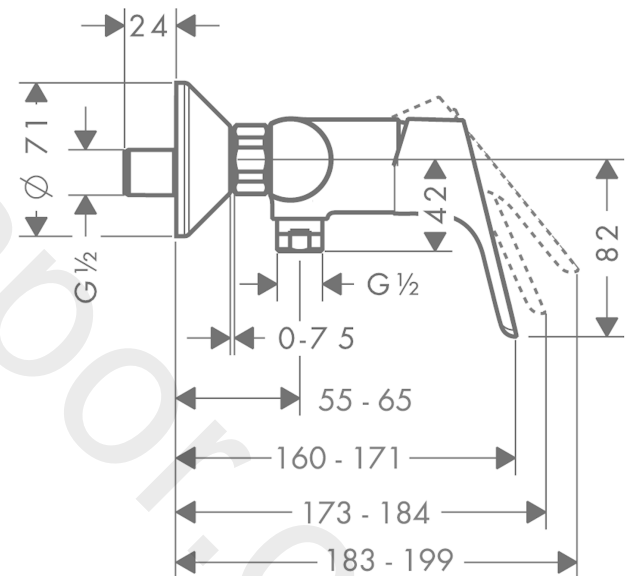

## Flowchart

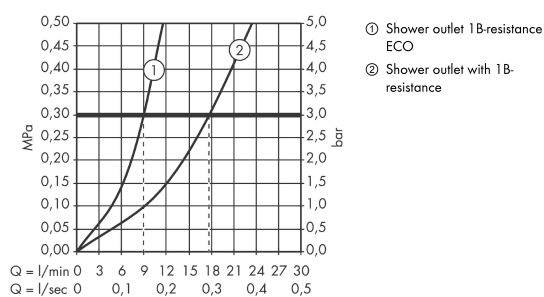

**Focus**

**Single lever shower mixer for exposed installation with 2 flow rates**

Finish: **Chrome** Article Number: **31968000**



**Exploded Drawing**

Year of production: >02/10

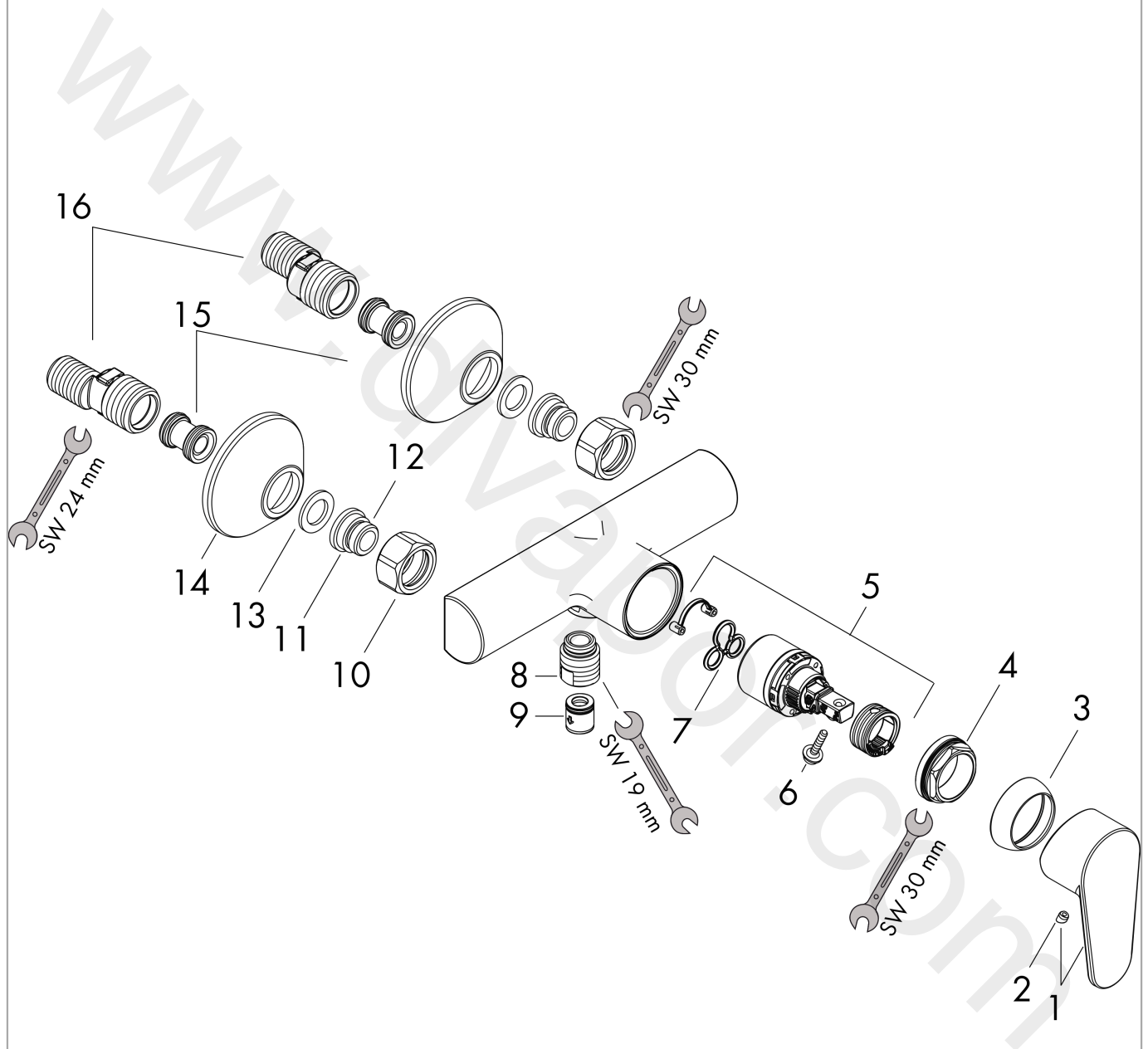

**Focus**

**Single lever shower mixer for exposed installation with 2 flow rates**

Finish: **Chrome** Article Number: **31968000**



**Spare part list**

Year of production: >02/10

Pos.	Description	Article Number	Price	PU
1	screw cover	96338000	£ 3,30	1
2	handle	98532000	£ 35,00	1
3	flange	97406000	£ 20,50	1
4	nut	97209000	£ 16,10	1
5	cartridge, assy	95730000	£ 43,00	1
6	locking screw for handle	95140000	£ 6,10	1
7	seal	95008000	£ 9,00	1
8	Hose Connection	96044000	£ 25,00	1
9	set of non return valves DW 15	94074000	£ 16,10	1
10	set of nuts	96157000	£ 35,00	1
11	connecting thread	97220000	£ 16,10	1
12	O-ring 15x2	98163000	£ 3,30	1
13	filter packing	96922000	£ 9,00	1
14	escutcheon Ø 70 mm	94135000	£ 13,30	1
15	noise reduction	96429000	£ 6,10	1
16	set of S-unions (±12 mm)	94140000	£ 51,00	1
a	set of S-unions (±32 mm)	98592000	£ 43,00	1