

AXOR Montreux
2-handle bath mixer for exposed installation with cross handles
Surfaces: Article Number: **16540830**

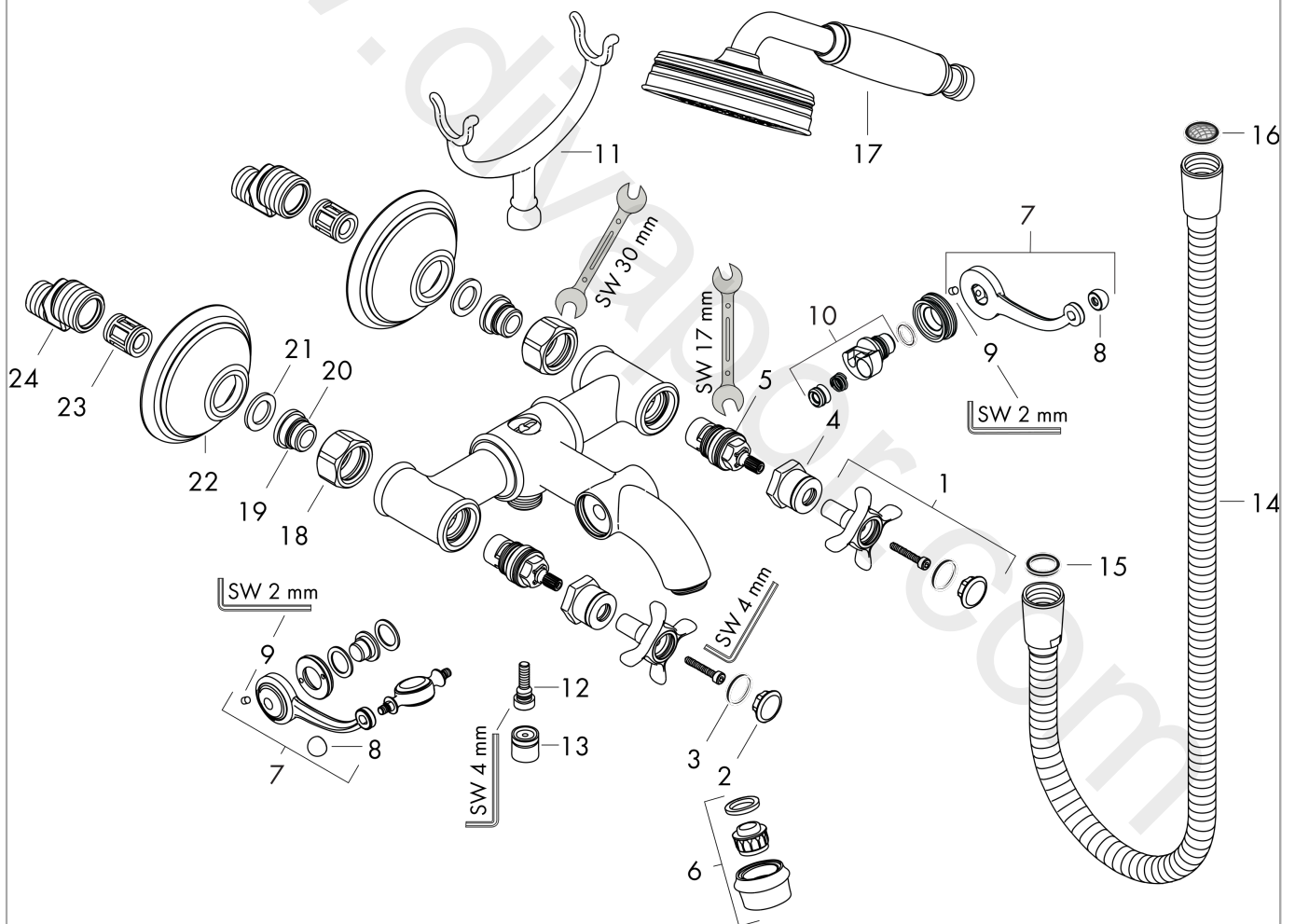

Exploded Drawing

Year of production: **04/06 - 12/11**



AXOR Montreux
2-handle bath mixer for exposed installation with cross handles
 Surfaces: Article Number: **16540830**



Spare part list

Year of production: **04/06 - 12/11**

| Pos. | | Article Number | Price | PU |
|------|---|----------------|----------|----|
| 1 | handle | 16597830 | £ 173,00 | 1 |
| 2 | set of screw covers, cold / hot water / neutral | 97987000 | £ 64,00 | 1 |
| 3 | O-ring 16x2 | 98133000 | £ 3,30 | 1 |
| 4 | sleeve | 97993830 | £ 64,00 | 1 |
| 5 | shut off unit right closing | 94009000 | £ 43,00 | 1 |
| 6 | aerator M22x1 (25 l/min) | 98575830 | £ 96,00 | 1 |
| 7 | sliding gear lever | 98594830 | £ 163,00 | 1 |
| 8 | set of nuts | 92852830 | £ 64,00 | 1 |
| 9 | hollow set screw M4x6 | 97767000 | £ 3,30 | 1 |
| 10 | selector | 98591000 | £ 96,00 | 1 |
| 11 | shower base | 98590830 | £ 64,00 | 1 |
| 12 | O-ring 5x2 | 98215000 | £ 3,30 | 1 |
| 13 | set of non return valves DW 15 | 94074000 | £ 16,10 | 1 |
| 14 | shower hose 1,60 m | 28116830 | £ 165,00 | 1 |
| 15 | seal | 98058000 | £ 3,30 | 1 |
| 16 | filter packing | 94246000 | £ 3,30 | 1 |
| 17 | handshower | 16320830 | £ 382,56 | 1 |
| 18 | set of nuts | 96157830 | £ 51,00 | 1 |
| 19 | connecting thread | 97220000 | £ 16,10 | 1 |
| 20 | O-ring 15x2 | 98163000 | £ 3,30 | 1 |
| 21 | filter packing | 96922000 | £ 9,00 | 1 |
| 22 | escutcheon | 98595830 | £ 51,00 | 1 |
| 23 | noise reduction | 96429000 | £ 6,10 | 1 |
| 24 | set of S-unions (±32 mm) | 98592000 | £ 43,00 | 1 |