

Ecoss

Single lever bath mixer for exposed installation DZR

Finish: **Chrome** Article Number: **14126000**



Description

product features

- consists of: single lever shower mixer
- 1 function
- centre distance: 150 ± 12 mm
- maximum flow rate at 3 bar: 17 l/min
- ceramic cartridge
- temperature limitation adjustable
- non-return valve
- suitable for continuous flow water heaters
- hose connection DN15
- connection type: s-shaped connections

Product image



Scale drawing

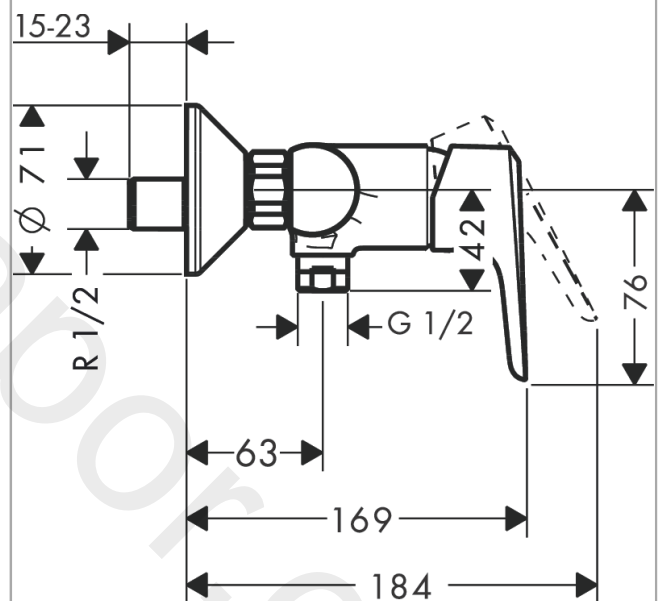

Flowchart

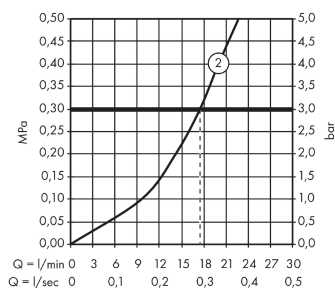

Shower outlet with 1B-resistance

Ecos
Single lever bath mixer for exposed installation DZR
 Finish: **Chrome** Article Number: **14126000**



Exploded Drawing

Year of production: >03/20

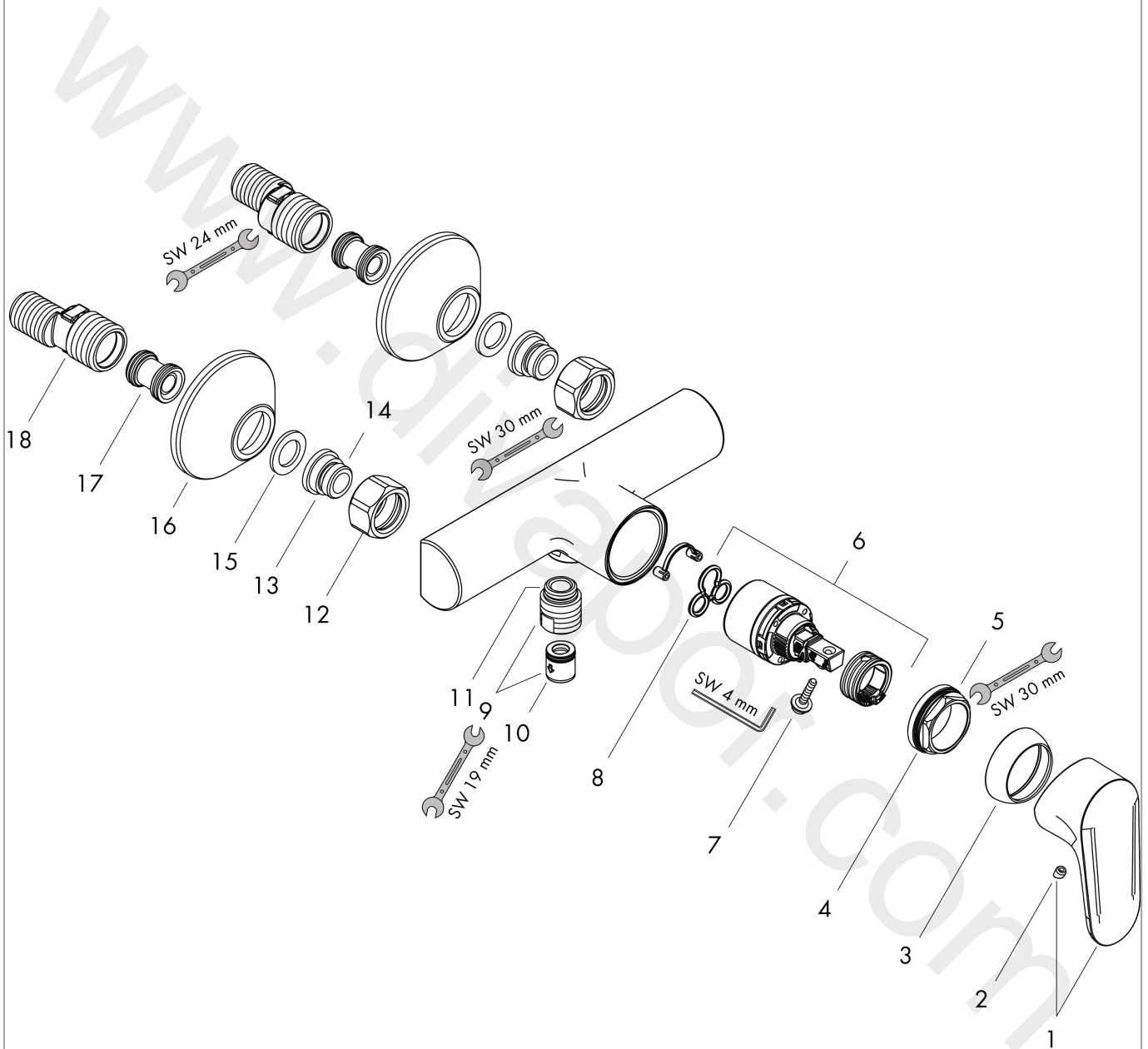

Ecos

Single lever bath mixer for exposed installation DZR

Finish: **Chrome** Article Number: **14126000**



Spare part list

Year of production: >03/20

Pos.	Description	Article Number	Price	PU
1	handle	95518000	£ 35,00	1
2	screw cover	96338000	£ 3,30	1
3	flange	97406000	£ 20,50	1
4	nut	97209000	£ 16,10	1
5	O-Ring 32x2	98193000	£ 3,30	1
6	cartridge, assy	92730000	£ 35,00	1
7	locking screw for handle	95140000	£ 6,10	1
8	seal	95008000	£ 9,00	1
9	Hose Connection	96044000	£ 25,00	1
10	O-ring 14x2	98129000	£ 3,30	1
11	set of non return valves DW 15	94074000	£ 16,10	1
12	set of nuts	96157000	£ 35,00	1
13	connecting thread	97220000	£ 16,10	1
14	O-ring 15x2	98163000	£ 3,30	1
15	filter packing	96922000	£ 9,00	1
16	escutcheon Ø 70 mm	94135000	£ 13,30	1
17	noise reduction	96429000	£ 6,10	1
18	set of S-unions (±12 mm)	94140000	£ 51,00	1