



Sink - VAIA

Lavatory spout, deck-mounted without drain - Chrome

Article number: 13 716 809-00 0010

Date of manufacture from 5/27/2021

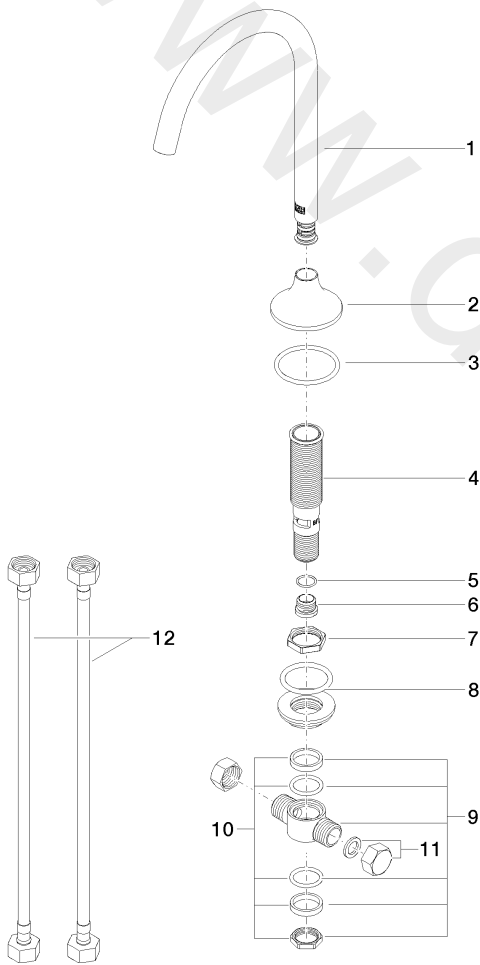



Sink - VAIA

Lavatory spout, deck-mounted without drain - Chrome

Article number: 13 716 809-00 0010

Date of manufacture from 5/27/2021

Spare parts list

Position	Number of units	Item Number	Spare part	Lead time
1	1	90 28 22 309 01-00	spout	10
2	1	09 27 80 011-00	rosette	10
3	1	09 14 10 084 90	seal	2
4	1	90 30 01 033 00 90	base	2
5	1	09 14 10 017 90	seal	2
6	1	09 24 04 021 10 90	nipple	2
7	1	09 23 10 127 90	nut	2
8	1	04 23 10 004 04 90	fixing set	2
9	1	04 17 11 020 10 90	distributor	2
10	1	90 23 10 012 00 90	gasket kit	2
11	2	04 21 02 006 00 92	cap	2
12	2	04 30 04 096 00 90	hose	2